

INSTALLATION INSTRUCTIONS

HDX LED GRILLE



APPLICATION:
2019 Ram 1500 (Excl. Classic)

PART NUMBER:
34-1145

CONTENT			
ITEM	QUANTITY	DESCRIPTION	TOOLS NEEDED
1	1	GRILLE	10MM WRENCH
2	2	LED LIGHT HOUSING	RATCHET
3	10	M6 HEX HEAD CAP SCREW (YELLOW ZINC)	TORQUE WRENCH
4	10	M6 HEX NUT (YELLOW ZINC)	SCREWDRIVER
5	10	M6 SPLIT LOCK WASHER (YELLOW ZINC)	ALLEN WRENCH
6	20	M6 FLAT WASHER (YELLOW ZINC)	DRILL
7	10	M8 BUTTON HEAD CAP SCREW (YELLOW ZINC)	10MM SOCKET
8	10	M8 SPLIT LOCK WASHER (YELLOW ZINC)	ANGLE GRINDER
9	10	M8 FLAT WASHER (YELLOW ZINC)	SAWZALL

ANTI-SEIZE LUBRICANT MUST BE USED ON ALL STAINLESS STEEL FASTENERS TO PREVENT THREAD DAMAGE AND GALLING

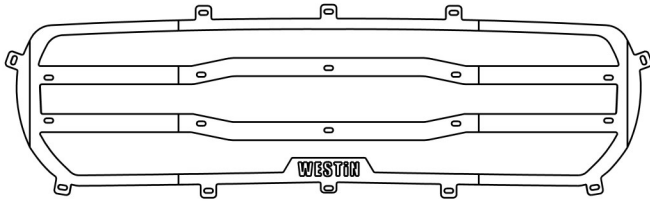

ITEM 1



ITEM 2

PROCEDURE

1. Remove contents from box, verify if all parts listed are present and free from damage.
Carefully read and understand all instructions before attempting installation.
Failure to identify damage before installation could lead to a rejection of any claim.

2. Open the hood and use a flathead screwdriver or pry tool to remove the clips securing the plastic cover See **Figure 1 & 2.**



3. Remove the 6mm bolts securing the top of the grille to the vehicle and remove the 6mm bolts securing the Top Lip to the Grille. See **Figures 3 & 4**

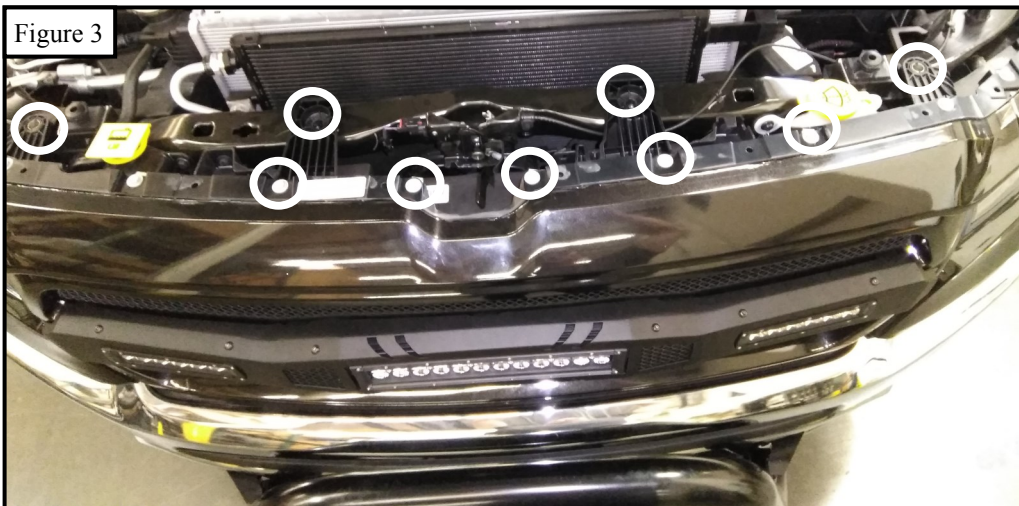

4. Detach clips securing plastic side panel to grille exposing the bottom bolts securing the grille to the vehicle. See **Figure 5**
5. Remove the bolts securing the bottom of the grille to the vehicle. See **Figure 6**

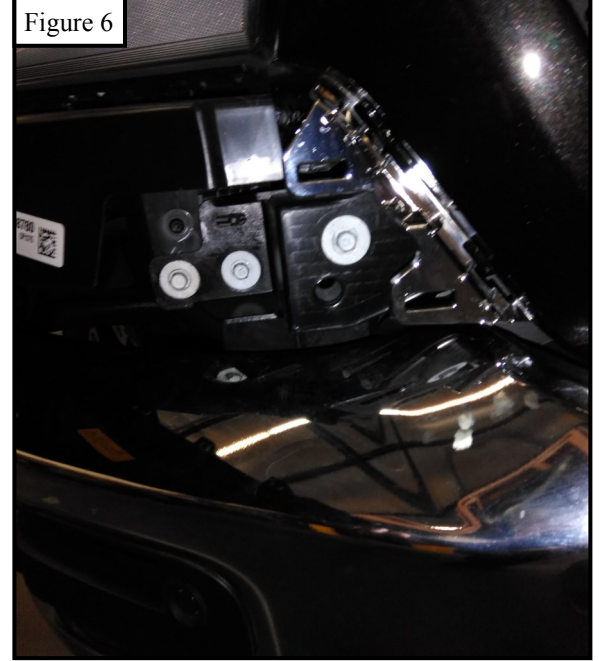

6. An exploded view of the OE Grille is shown below. The OE Grille will be disassemble and then reassembled with the HDX LED Grille. See **Figure 7**

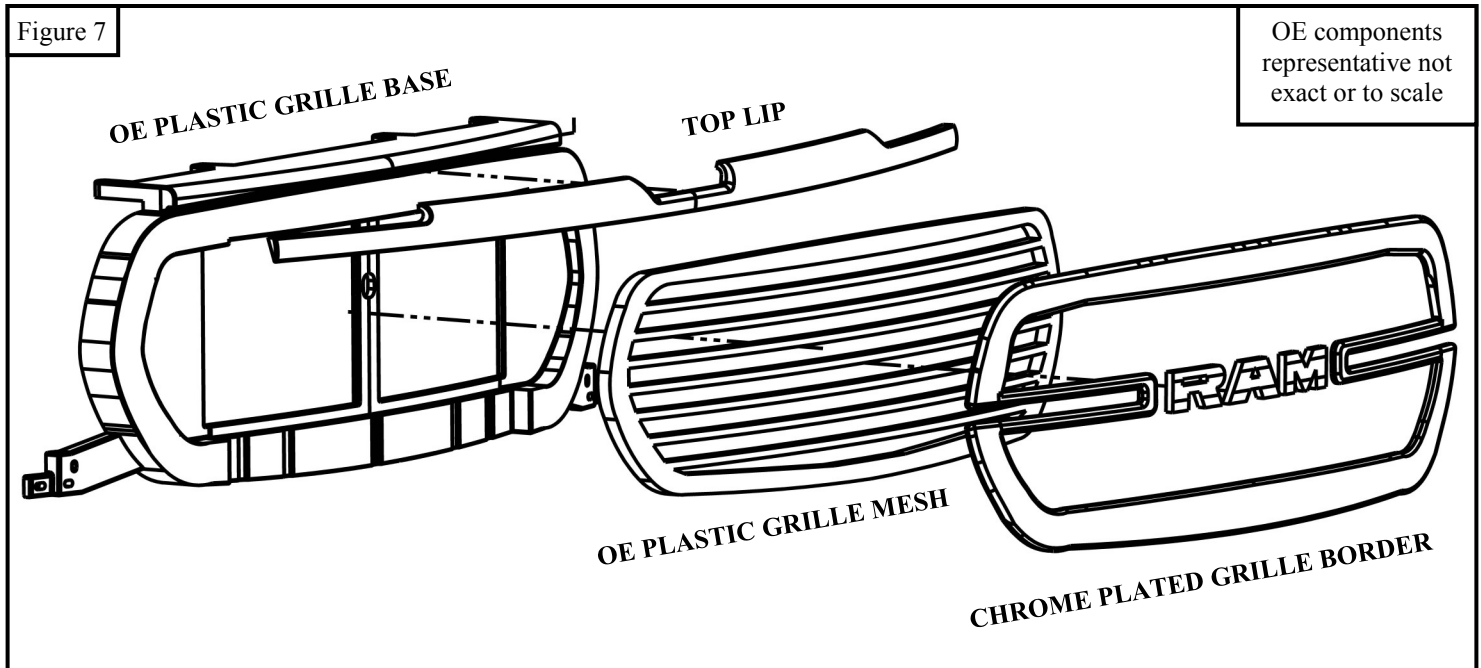

7. Remove screws securing the OE Plastic Grille Base to the OE Plastic Grille Mesh. See **Figure 8 & 9**

Figure 8

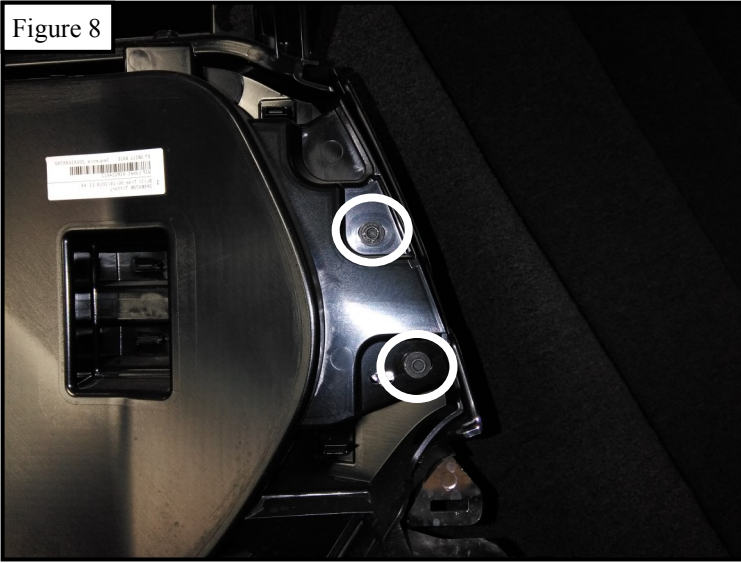

Figure 9



8. Detach clips securing the OE Plastic Grille Base to the OE Plastic Grille Mesh. See **Figure 10**

9. Detach clips securing the OE Plastic Grille Mesh to the Chrome Plated Border. See **Figure 11**

Figure 10

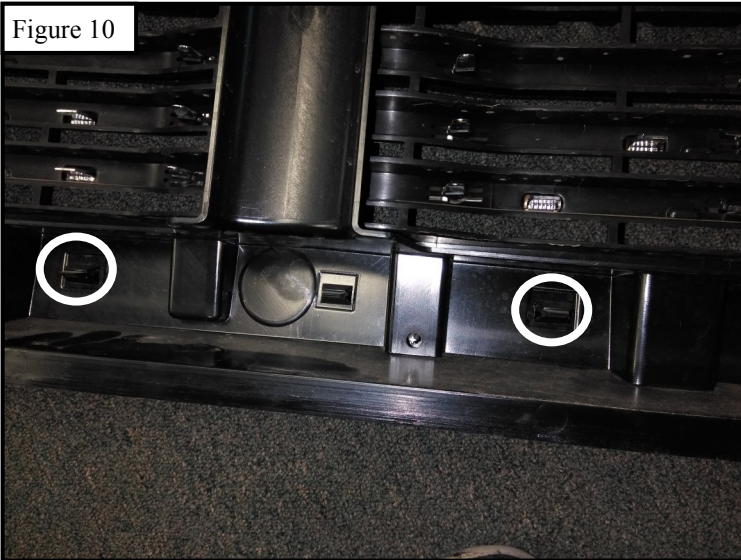
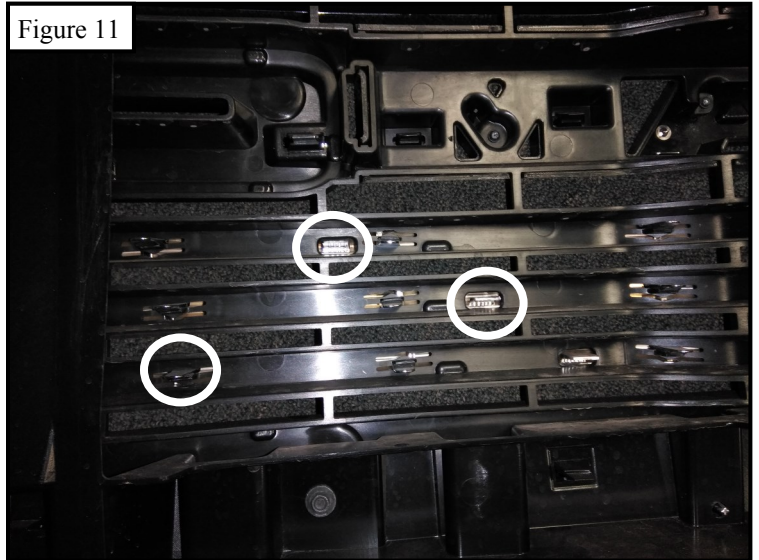

Figure 11



10. The HDX LED Grille will be assembled with the components of the OE Grille. (**Note:** The OE Plastic Grille Base will need to be cut.) See Pg. 6
11. Assemble the grille (**Item 1**) with the OE Plastic Grille Mesh using the supplied M6 hardware. See **Figure 13** (**Note:** The OE Plastic Grille Mesh will need to be cut.) See Pg. 7
12. Assemble the preassemble grille (**Item 1**) and OE Plastic Grille Mesh to the Chrome Plated Grille Border and the LED Light Housing (**Item 2**) using the supplied M8 hardware. See **Figure 14** (**Note:** Chrome Plated Grille Border will need to be cut.) See Pg. 6

Figure 13

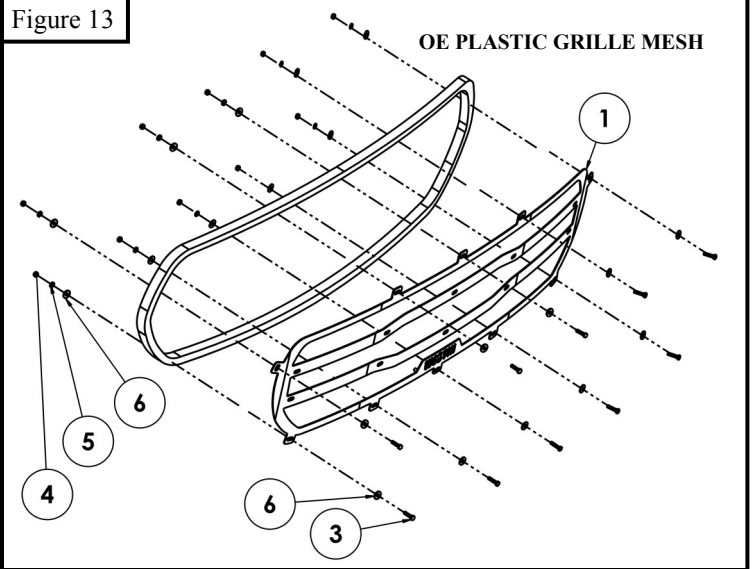

Figure 12

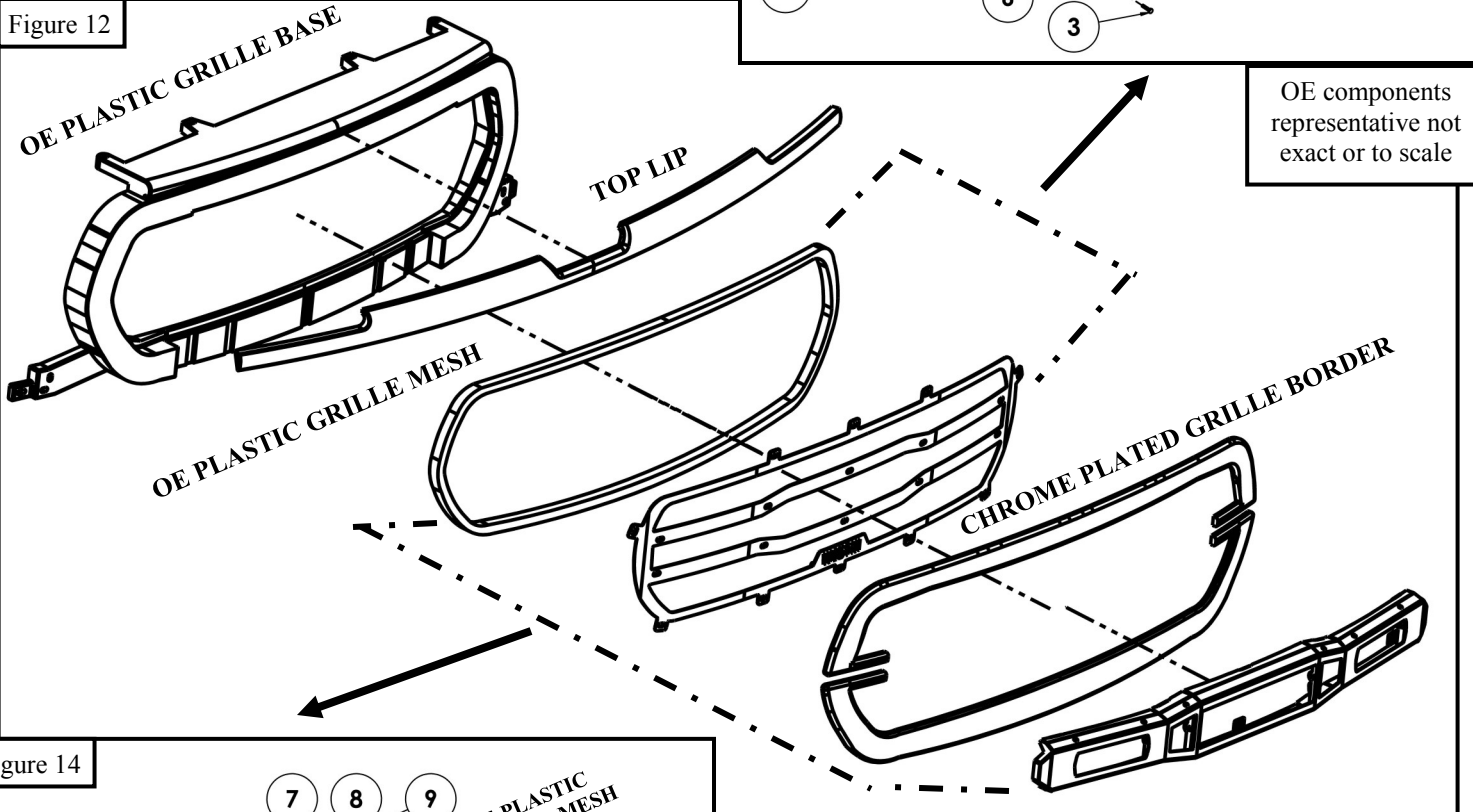
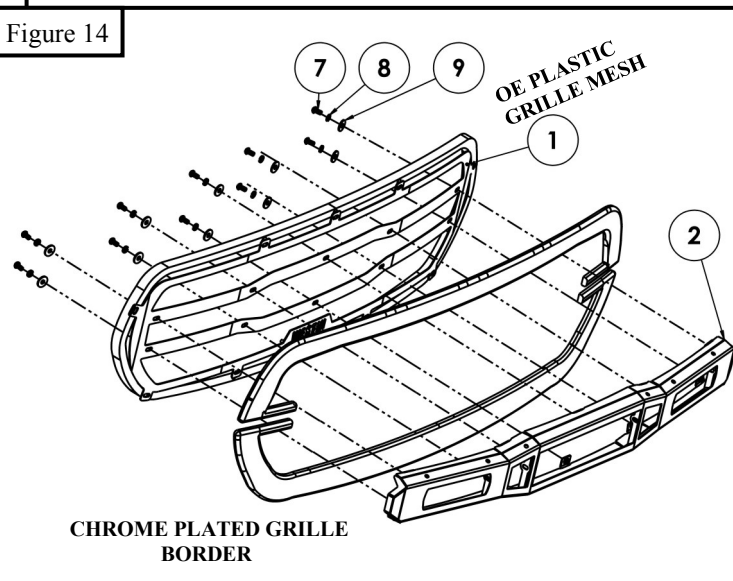

Figure 14



13. Torque all M6 hardware to 7ft-lbs and all M8 hardware to 16 ft-lbs.

NOTE: SEE PG. 7 LINE 17 FOR BEST LOOK AND CENTERING GRILLE

14. Once all components of OE Grille are disassembled, the OE Grille Base will be cut in order to avoid interference with the lights. See **Figure 15 & 16.**

15. The Chrome Plate Grille Boarder will be cut as well. See **Figures 17 & 18.**

Figure 15

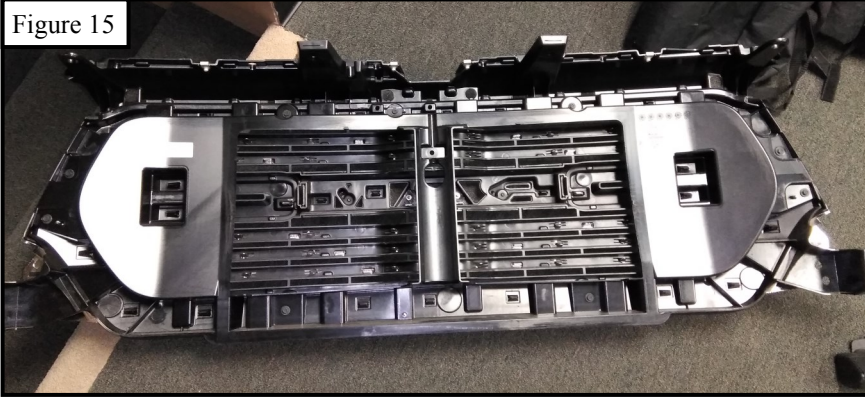

Figure 16



Figure 17



Figure 18



16. The OE Plastic Grille Mesh will need to be cut so that only the border with the clips are salvaged. The inside corners may need to be cut further in, in order to lay the grille on top flush. See **Figures 19 & 20**
17. Once the mesh on the OE Plastic Grille Mesh is cut out, lay the grille (**Item 1**) flush on top. Line up the Chrome Plated Grille Border on top of the grille (**Item 1**). (Note: this will help in centering the grille and help with reducing gaps). Line it up so it is centered, remove Chrome Plated Grille Border and mark the slots where 1/2" holes will need to be drilled on the OE Plastic Grille Mesh. See **Figures 18**
18. Continue by assembling the OE Plastic Grille Mesh with the grille (**Item 1**) with the supplied M6 hardware. See **Figures 20, & See Pg. 5**

Figure 19

OE component representative
not exact or to scale

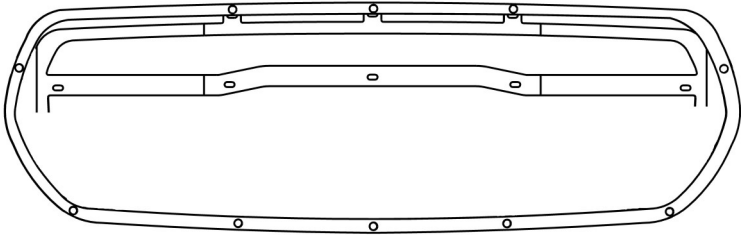

Figure 20



19. Extra holes and cutting will be needed on the OE Plastic Grille Base in order to give clearance to the bolts use to secure the HDX LED Grille. See **Figure 21**
20. Reassemble the OE Grille components with the HDX LED Grille components in the reverse order detailed in the instructions. See **Pg. 5**
21. Torque all M6 hardware to 7ft-lbs and all M8 hardware to 16 ft-lbs.

Figure 21



INSTALLATION COMPLETE



Roof Rack, Step Bars, Tent, and
Bumper Sold Separately

© ALL RIGHTS RESERVED

CARE INSTRUCTIONS

- REGULAR WAXING IS RECOMMENDED. DO NOT USE ANY TYPE OF POLISH OR WAX THAT MAY CONTAIN ABRASIVES.
- STAINLESS STEEL PRODUCTS CAN BE CLEANED WITH MILD SOAP AND WATER. STAINLESS STEEL POLISH SHOULD BE USED TO POLISH SMALL SCRATCHES.
- GLOSS BLACK FINISHES SHOULD BE CLEANED WITH MILD SOAP AND WATER.

WESTIN

Westin Automotive Products, Inc.
320 W. Covina Blvd
San Dimas, Ca. 91773

Thank you for choosing Westin products
for additional installation assistance please call
Customer Service (800) 793-7846

www.westinautomotive.com

WESTIN recommends using a professional for this installation.

1. Disconnect ground connection from battery (-) to avoid accidental short circuits before attempting to connect electrical wires.
2. When running wires, avoid areas of excessive heat, vibration, pinch or rotation when securing harness to vehicle.
3. Always use a fused (+) positive supply source.
4. This light becomes hot under continuous use. Do not remove or touch the casting for at least 30 minutes after the lamp has been turned off.

Refer to Figure 8.

1. Locate wiring harness and mount the switch in a convenient location where it is easily accessible from the drivers seat.
Note: *The switch will need to be removed from the wiring harness so that the rest of the harness can be routed from the engine bay to the cabin.*
2. Route the wiring harness wire, specifically the fuse and relay, from the positive battery terminal along the firewalls existing wire routes. **Note:** *Tape as necessary to correct slack.*
3. Secure the relay by either drilling or using a pre-existing bolt along the chassis that is not connected to any other wire.
4. Run the switch harness through the firewall preferably through the pre-existing rubber plug that is used to run the OEM wiring harness from the engine bay to fuse box. **Note:** *Reconnect the switch to the wiring harness.*
5. Place the LED plug wire along the fender chassis where it will not get pinched and away from any moving parts (fan, pulleys etc.).
6. Run the attached wire from the LED Light Bar as previously mentioned away from any moving parts.
7. Connect both ends of wiring connectors from LED light bar and wiring harness.
8. Re-connect battery terminals, attach the Red (+) wire to battery positive, and the black (-) wire to ground. **Note:** *Add dielectric grease (not supplied).*
9. Turn on the switch to make sure if the lamp works. If not, please check carefully if the wiring installation is correct.

Figure 6

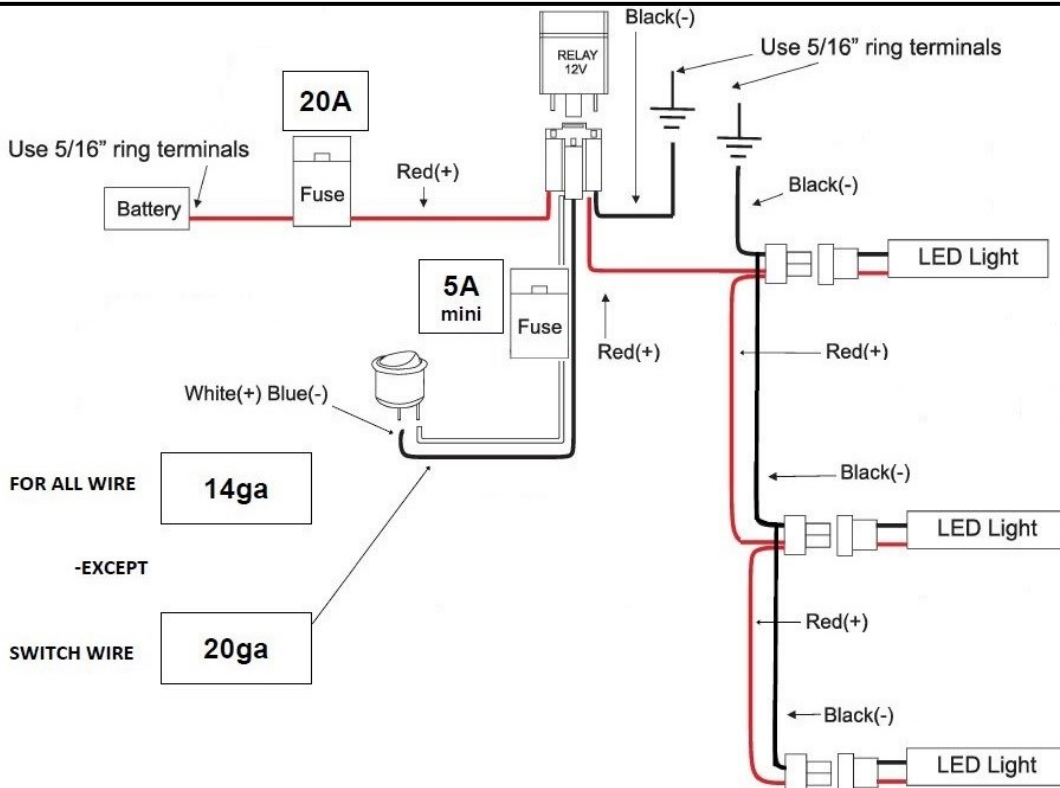



WARNING



Failure to follow these instructions could lead to death, personal injury, and / or property damage.

Failure to follow these instructions could lead to death, personal injury, and / or property damage.

FASTENERS:

All Westin supplied fasteners must be utilized and installed in accordance with the installation instructions and apply torque to the specifications as defined. **DOUBLE CHECK ALL FASTENERS BEFORE INITIAL USE, AND PERIODICALLY IN THE FUTURE TO ENSURE PROPER FUNCTION AND SAFETY.**

DRILLING:

Most Westin products do not require drilling for installation. If drilling is defined as required, use caution when drilling a vehicle. **FAILURE TO REVIEW AN AREA TO BE DRILLED MAY RESULT IN PERSONAL INJURY AND/OR INJURY TO OTHERS AS WELL AS VEHICLE DAMAGE.**

EYE PROTECTION:

ALWAYS WEAR SAFETY GLASSES OR GOGGLES DURING THE INSTALLATION PROCESS TO AVOID PERSONAL INJURY.

MAXIMUM TOWING/CARRYING CAPACITY: (if applicable)

The Westin Receiver Hitches will have a visible tow rating label affixed directly on the product. User should never exceed the vehicle manufacturers maximum tow and weight rating regardless of the capacity of the hitch. **FAILURE TO FOLLOW THESE GUIDELINES WILL VOID THE WESTIN WARRANTY AND MAY RESULT IN PERSONAL INJURY AND/OR INJURY TO OTHERS AS WELL AS VEHICLE DAMAGE.**

FOR CALIFORNIA RESIDENTS ONLY-PROP 65 WARNING:

Some products may contain chemicals such as DEHP, which can cause cancer, birth defects or other reproductive harm. For more info go to www.p65warnings.ca.gov