



INSTALLATION INSTRUCTIONS

2.5" CONTOUR BAR

AUTOMOTIVE PRODUCTS,

APPLICATION:

2013-2015, GM, Acadia
2013-2015, Chevy, Traverse
2013-2015, Buick, Enclave

PART NUMBER:

32-21090, 32-21095

CONTENT			
ITEM	QUANTITY	DESCRIPTION	TOOLS NEEDED
1	1	CONTOUR BAR ASSEMBLY	RATCHET
2	1	PASSENGER SIDE MOUNTING BRACKET	TORQUE WRENCH
3	1	DRIVER SIDE MOUNTING BRACKET	15MM SOCKET
4	2	M10 LONG HEX HEAD BOLT (YELLOW ZINC)	16MM SOCKET
5	2	M10 LOCK WASHER (YELLOW ZINC)	10MM SOCKET
6	2	M10 FLAT WASHER (YELLOW ZINC)	13MM SOCKET
7	2	M12 HEX HEAD BOLT (YELLOW ZINC)	18MM SOCKET
8	2	M12 LOCK WASHER (YELLOW ZINC)	SOCKET EXT.
9	4	M12 LARGE FLAT WASHER (YELLOW ZINC)	
10	2	M8 HEX HEAD BOLT (YELLOW ZINC)	
11	2	M8 LOCK WASHER (YELLOW ZINC)	
12	4	M8 FLAT WASHER (YELLOW ZINC)	
13	2	M8 HEX NUT (YELLOW ZINC)	
14	2	ROUND SPACER 10MM THICK (YELLOW ZINC)	

ANTI-SEIZE LUBRICANT MUST BE USED ON ALL STAINLESS STEEL FASTENERS TO PREVENT THREAD DAMAGE AND GALLING

IMPORTANT ALERT: GM uses a very strong thread-locking compound on all body bolts. Use of an air assisted impact ratchet can cause damage to the threads on factory body mount bolts and the internal nut assembly because of this thread locking compound.

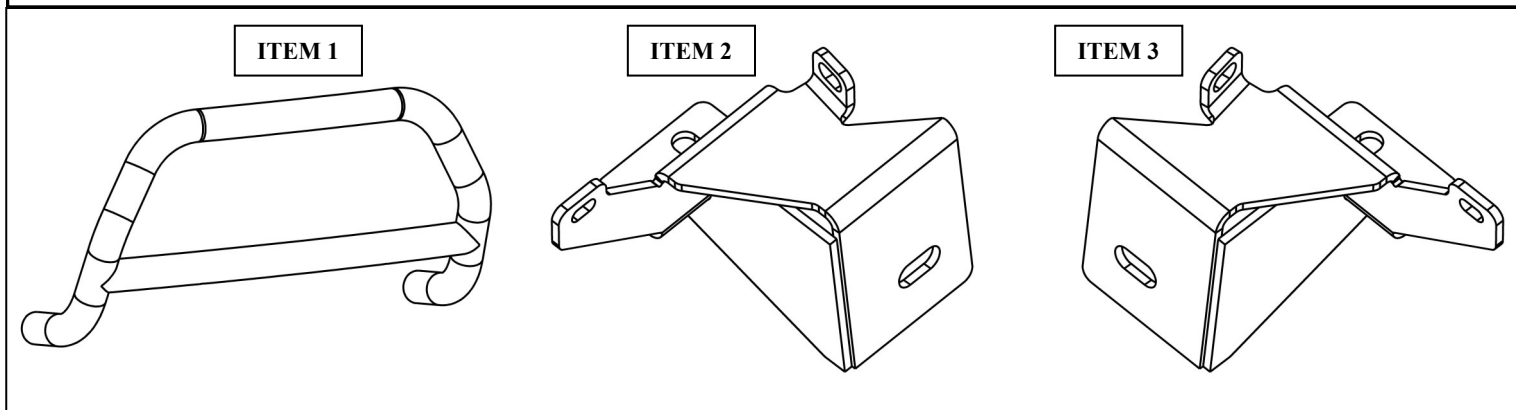

Westin Automotive Products, Inc.
320 W. Covina Blvd
San Dimas, Ca. 91773

Thank You for choosing Westin products
For Additional installation assistance please call
Customer service (800) 793-7846

PROCEDURE

1. Remove contents from box, verify if all parts listed are present and free from damage. Carefully read and understand all instructions before attempting installation.
2. Trim designated area on vehicles valence. Check the alignment of your bracket with the mounting location so you know the general area to trim. **See Figure 1.**
3. Remove the factory M10 bolt closest to the center of the vehicle. Loosely install mounting bracket with supplied M10 hardware, M12 large washer, and round spacer. **See Figure 2.**

Figure 1

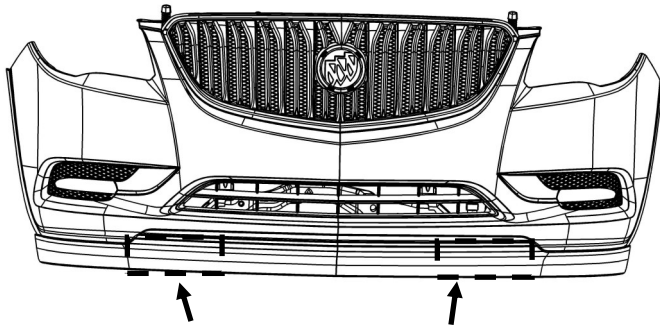
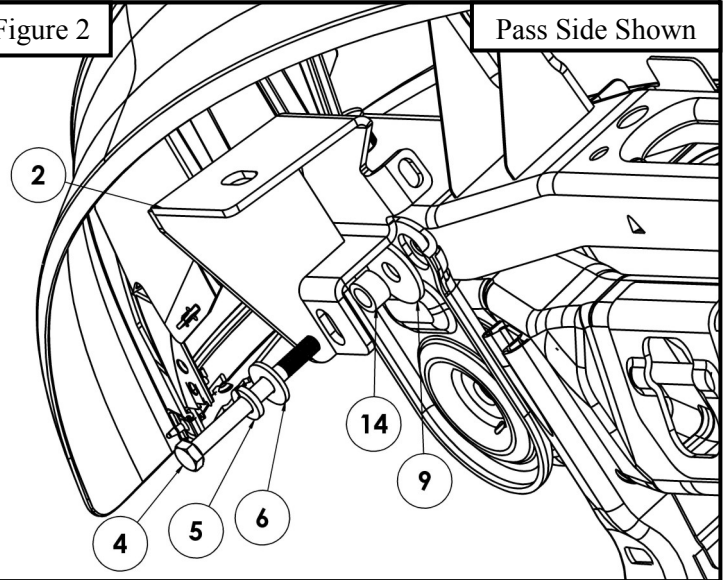

Figure 2

Pass Side Shown



4. Remove factory M6 bolt from factory welded nut. Pry plastic part back to slide mounting bracket into alignment with hole. Then loosely install mounting bracket behind plastic with M6 factory bolt **See Figure 3.**
5. **Optional:** If mounting bracket is not sturdy enough as installed, there is an option to drill a 7/16" hole through the frames sheet metal, where the slot aligns. Loosely install mounting bracket with supplied M8 hardware. **See Figure 4**

Figure 3

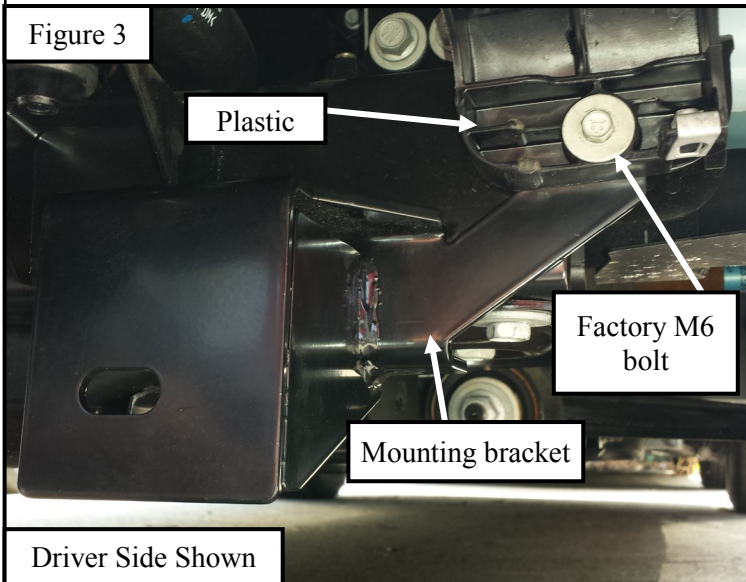
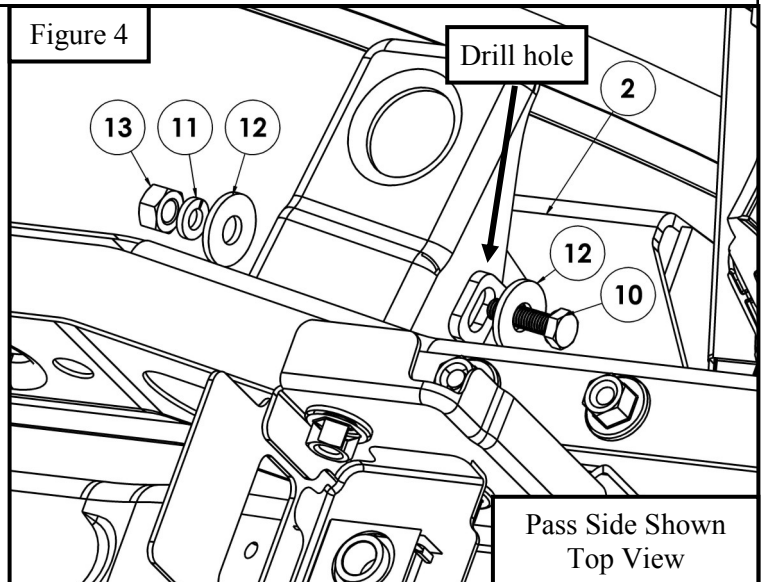
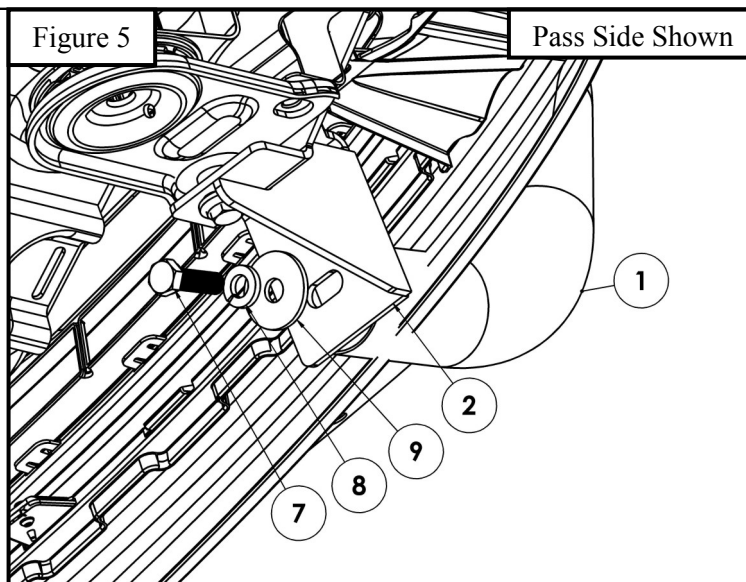

Figure 4



Westin Automotive Products, Inc.
320 W. Covina Blvd
San Dimas, Ca. 91773

6. Loosely install contour bar to mounting bracket with supplied M12 hardware. **See Figure 5.**
7. Align bar to desired positioning then torque and tighten all: M6 hardware to 8 ft-lbs, M8 hardware to 19 ft-lbs, M10 hardware to 53 ft-lbs, and M12 hardware to 65 ft-lbs.



INSTALLATION COMPLETED



Care Instructions

- REGULAR WAXING IS RECOMMENDED. DO NOT USE ANY TYPE OF POLISH OR WAX THAT MAY CONTAIN ABRASIVES.
- STAINLESS STEEL PRODUCTS CAN BE CLEANED WITH MILD SOAP AND WATER. STAINLESS STEEL POLISH SHOULD BE USED TO POLISH SMALL SCRATCHES..
- GLOSS BLACK FINISHES SHOULD BE CLEANED WITH MILD SOAP AND WATER.



Westin Automotive Products, Inc.
320 W. Covina Blvd
San Dimas, Ca. 91773

Thank You for choosing Westin products
For Additional installation assistance please call
Customer service (800) 793-7846
www.westinautomotive.com

OPTIONAL LIGHT MOUNT TABS

ITEM	QUANTITY	DESCRIPTION	TOOLS NEEDED
15	2	LIGHT MOUNT BRACKET TABS	HEX KEY TOOL (INCLUDED)
16	2	M10 BUTTON HEAD CAP SCREW	
17	2	M10 TOOTHED LOCK WASHER	
18	2	M10 FLAT WASHER	
19	1	ADHESIVE FOAM TAPE	

PROCEDURE

1. Remove contents from box, verify if all parts listed are present and free from damage. Carefully read and understand all instructions before attempting installation.
2. Apply foam tape to front and back of the tab facing where it mounts to the tube. **See Figure 6.**
3. Using the supplied hex key tool, button head cap screws, lock washers, and flat washers, attach the bracket tabs to the threaded inserts in the bottom of the cross tube. **See Figure 7.**

Figure 6



Figure 7

