



INSTALLATION INSTRUCTIONS

APPLICATION: 2009-2015 DODGE RAM 1500
APP PART #'S: 32-31050, 32-31055, 32-31055T
3.5" CONTOUR BULL BAR

AUTOMOTIVE PRODUCTS, INC.

ITEM	QUANTITY	DESCRIPTION	TOOLS NEEDED
1	1	CONTOUR BULL BAR	RATCHET
2	1	DRIVER LOWER MOUNTING BRACKET	TORQUE WRENCH
3	1	PASSENGER LOWER MOUNTING BRACKET	16MM WRENCH
4	1	DRIVER UPPER SUPPORT STRAP	16MM SOCKET
5	1	PASSENGER UPPER SUPPORT STRAP	18MM WRENCH
6	2	UPPER FRAME MOUNTING BRACKET	18MM SOCKET
7	2	LOWER SUPPORT STRAP	10MM SOCKET
8	4	M10-1.50 HEX NUT (YELLOW ZINC)	FLAT HEAD SCREWDRIVER
9	6	M10 FLAT WASHER 20MM OD X 2MM THICK (YELLOW ZINC)	HAMMER
10	4	M10 SPLIT LOCK WASHER (YELLOW ZINC)	
11	2	M10-1.50X120MM HEX HEAD CAP SCREW, CLASS 8.8 (YELLOW ZINC)	
12	2	M10 FLAT WASHER 34MM OD X 3MM THICK (YELLOW ZINC)	
13	2	M10-1.50X30MM HEX HEAD CAP SCREW, CLASS 8.8 (YELLOW ZINC)	
14	8	M12 FLAT WASHER 24MM OD X 2.5MM THICK (YELLOW ZINC)	
15	4	M12 SPLIT LOCK WASHER (YELLOW ZINC)	
16	4	M12-1.75 HEX NUT (YELLOW ZINC)	
17	4	M12-1.75X35MM HEX HEAD CAP SCREW, CLASS 8.8 (YELLOW ZINC)	
18	2	M10-1.50 X 30MM HEX HEAD CAP SCREW (STAINLESS STEEL)	
19	2	M10 FLAT WASHER 20MM OD X 2MM THICK (STAINLESS STEEL)	
20	2	M10 SPLIT LOCK WASHER (STAINLESS STEEL)	
21	4	M12-1.75X35MM HEX HEAD CAP SCREW (STAINLESS STEEL)	
22	2	M12-1.75X50MM HEX HEAD CAP SCREW (STAINLESS STEEL)	
23	8	M12 FLAT WASHER 24MM OD X 2.5MM THICK (STAINLESS STEEL)	
24	4	M12 SPLIT LOCK WASHER (STAINLESS STEEL)	
25	4	M12-1.75 HEX NUT (STAINLESS STEEL)	

ANTI-SEIZE LUBRICANT MUST BE USED ON ALL STAINLESS STEEL FASTENERS TO PREVENT THREAD DAMAGE AND GALLING



Westin Automotive Products, Inc.
320 W. Covina Blvd
San Dimas, Ca. 91773

Thank You for choosing Westin products
For Additional installation assistance please call
Customer service (800) 793-7846

www.westinautomotive.com

PROCEDURE

1. Remove contents from box, verify if all parts listed are present and free from damage. Carefully read and understand all instructions before attempting installation. **Failure to identify damage before installation could lead to a rejection of any claim.**
 - A. **2009-2012 Models without tow hooks and 2009-2015 Express and Sport models:** Removal or trimming of blank filler panel in bumper is required in order to allow attachment of upper support straps to bull bar. Remove the inserts by removing the 2-piece plastic clips at the top of the panel. Use a flat-blade screwdriver to first pop the center pin out to release the clip. See **Figures 1 & 3.**
 - B. **2013-2015 Models without tow hooks:** Remove the two plastic covers in the bumper by removing the (4) M6 fasteners from the inside of the bumper. Refer to **Figures 2 & 4.**

(2009-2012 Models) Filler panel with trimmed slots shown. 2009-2015 Sport and Express models.

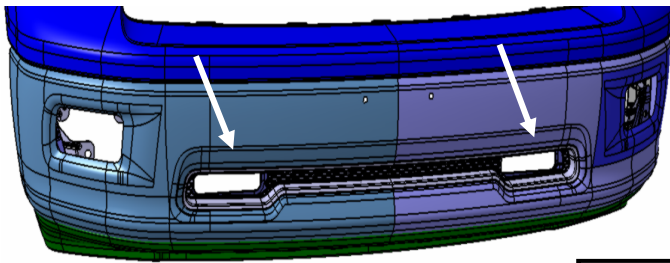

Fig.1

(2013-2015 Models) Location of bumper plastic inserts.

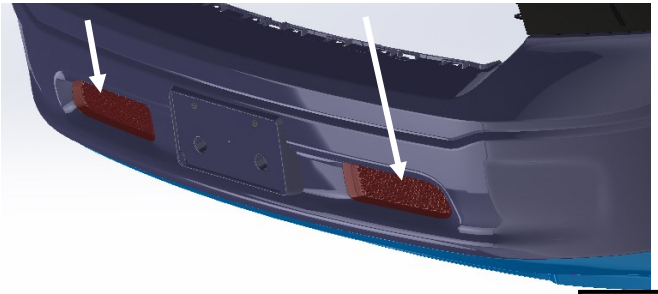

Fig.2

Remove these plastic clips.

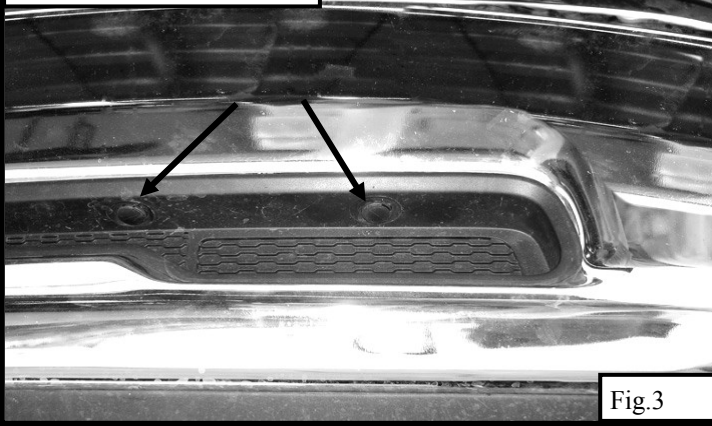

Fig.3

(2013+ vehicles) Remove these M6 bolts from the backside of the bumper (four per side).

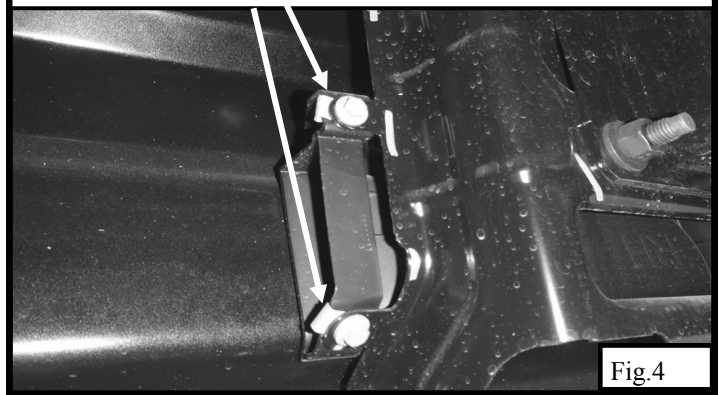

Fig.4



Westin Automotive Products, Inc.
320 W. Covina Blvd
San Dimas, Ca. 91773

2. Start installation on the driver side from underneath the front of the vehicle. Locate the two hex nuts on the lower bumper mount and remove them (**FIG 5**). **NOTE:** For vehicles with factory tow hooks, it is only necessary to remove the nuts inboard toward the center of the vehicle.
3. Drive the inboard carriage bolts in the bumper bracket out of the bracket by striking the end of the bolts with a hammer (**FIG 6**). Discard the tin retaining washers.

Remove these two bolts and nuts (Non-tow hook model).
NOTE: If equipped with tow hooks, only remove inner nuts.

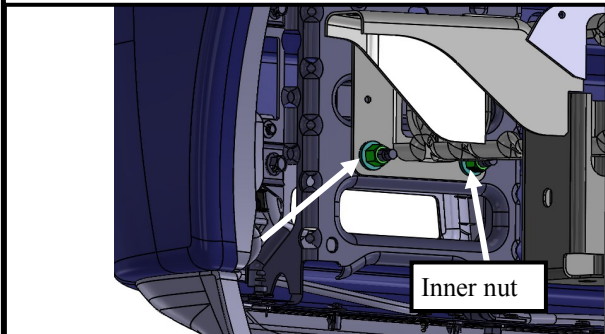

Fig. 5

Remove inner bolts



Do not remove this bolt.

Fig. 6

4. Installation of upper frame mounting brackets.
 - A. **For vehicles w/o tow hooks:** Place the upper frame mounting bracket (**Item #6**) up against the frame of the vehicle as shown in **Figure 7**. Make sure to align the holes of the bracket with those of the frame.
 - B. **For vehicles equipped with tow hooks:** Don't use the upper frame mounting bracket.
5. Loosely install the upper support strap (**Item #4**) to the opposite side of the frame, through the tow hook pocket. Refer to **Figure 8** for a picture showing the correct mounting location of the upper support strap. For the inner hole, secure the support strap and upper frame bracket by using the provided long M12 hex head cap screw (**Item #22**) and the nut removed in step 2 (**FIG 7**). (**NOTE:** Stock bolt will not be re-used for the inner hole). For the outer hole reuse the stock hardware removed in step 2.)

Mounting location of upper frame bracket (**Item #6**).
NOTE: Use bracket only for vehicles not equipped with tow hooks (Driver side shown).

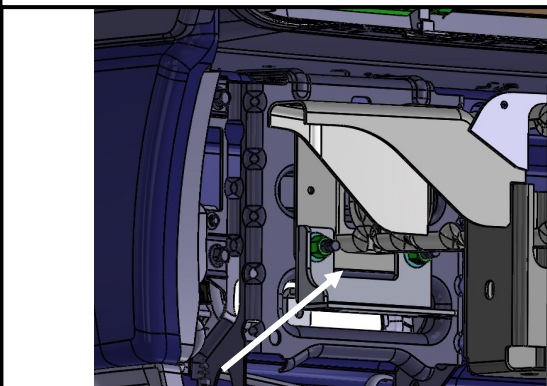

Fig. 7

Upper support strap (**Item #4**) mounting location on a non-tow hook model. Strap mounts to same location for vehicles equipped with tow hooks (Driver side shown).

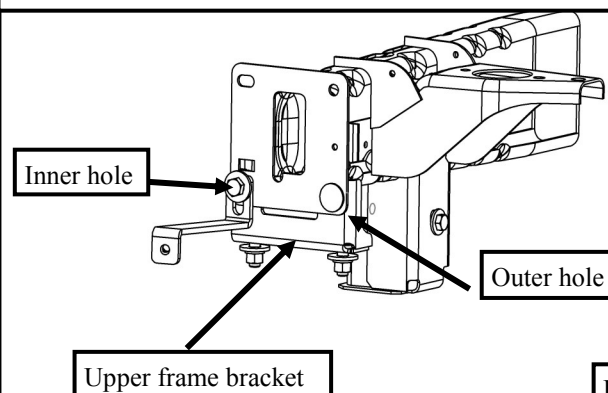

Fig. 8

6. Attachment of lower mounting brackets.

- A. **Vehicles w/o tow hooks:** Attach the lower mounting bracket (**Item #2**) to the previously installed upper frame bracket (**See Figure 9**) using (2) M12 hex head cap screws (**Item #17**), (4) M12 flat washers (**Item #14**), (2) M12 split lock washers (**Item #15**), and (2) M12 hex nuts (**Item #16**). See **Figure 14** for a picture showing the hardware used.
- B. **Vehicles with tow hooks:** Remove the stock nuts shown in **Figure 10** and place the lower mounting bracket up against the tow hook (**FIG 11**). Make sure to align the holes of the bracket with those of the tow hook. Secure the bracket to the tow hook by re-using the stock hardware.

Lower mounting bracket (**Item #2**) installed on a **non-tow hook model** (Driver side shown).

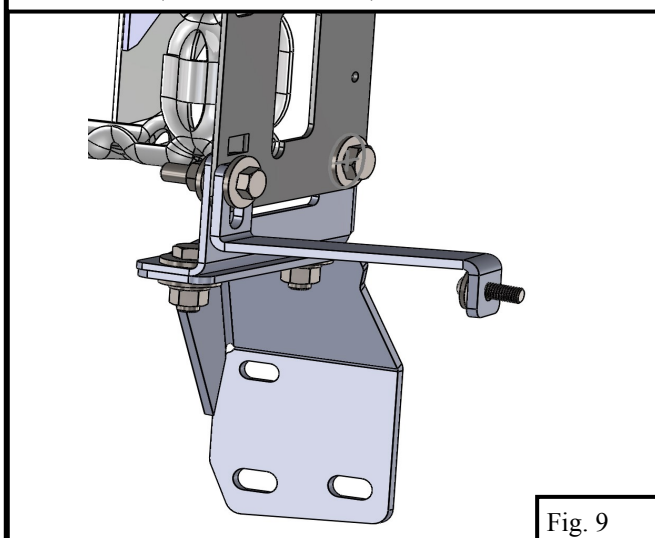

Fig. 9

Vehicle equipped **with tow hooks**. Remove these two nuts (Driver side shown).

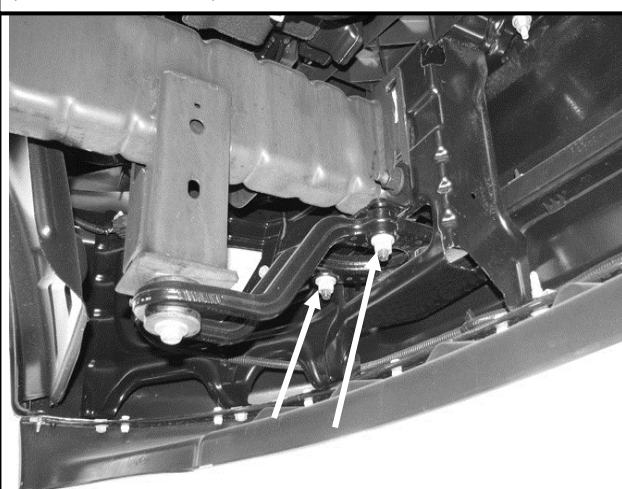

Fig. 10

Bracket mounted underneath tow hook.
(Driver side shown)

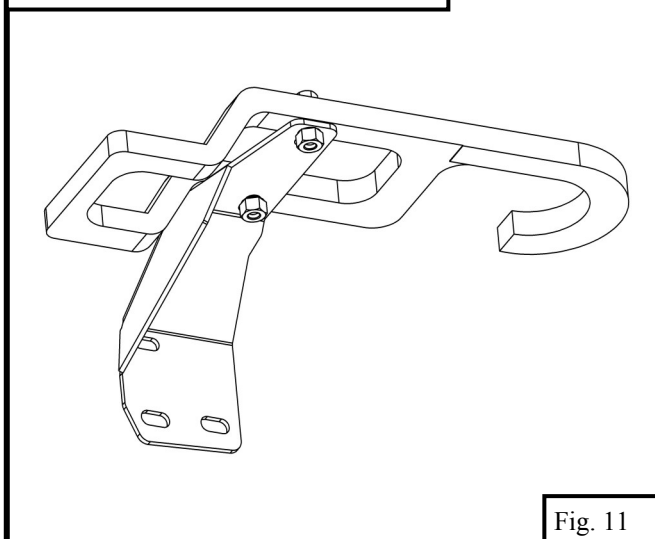

Fig. 11

Location of cut outs in front valence

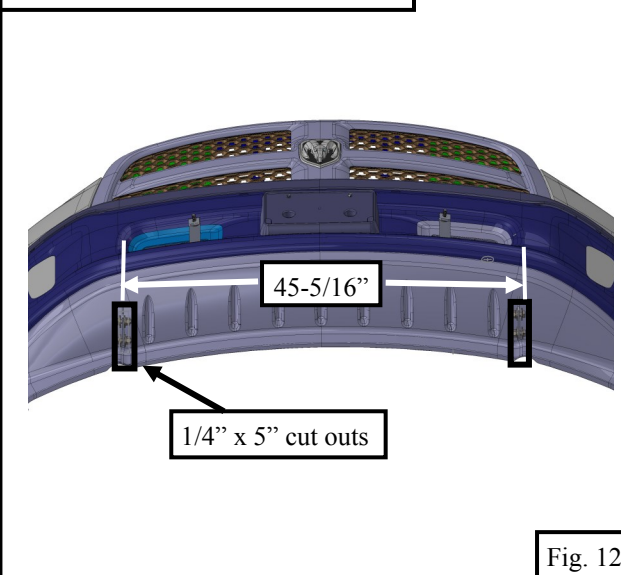
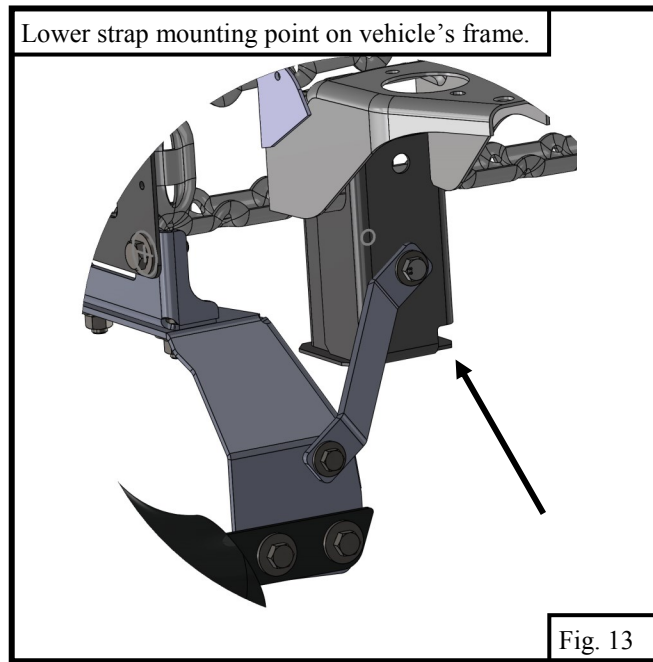

Fig. 12

7. Trimming of the front valence is required in order to install the lower mounting brackets. From outer flange to outer flange, the lower brackets should measure 45-5/16". The approximate dimensions for the cut outs are shown in **Figure 12**. (NOTE: Trim as necessary.)



8. Loosely attach one end of the lower support strap to the lower mounting bracket using (1) M10 hex head cap screw (**Item #13**), (2) M10 flat washers (**Item #9**), (1) M10 split lock washer (**Item #10**), and (1) M10 hex nut (**Item #8**). The other end of the lower support strap will be mounted to the vehicle's frame in the location shown in **Figure 13** using (1) M10 hex head cap screw (**Item #11**), (1) M10 flat washer (**Item #9**), (1) M10 large flat washer (**Item #12**), (1) M10 split lock washer (**Item #10**), and (1) M10 hex nut (**Item #8**). Refer to **Figure 14** for a picture showing the mounting hardware.
9. Repeat steps 2-8 for passenger side.
10. With assistance, hold the bull bar up in position on the outside of the lower mounting brackets. Loosely install the bull bar to the brackets with (4) M12 hex head cap screws (**Item #21**), (8) M12 flat washers (**Item #23**), (4) M12 split lock washers (**Item #24**), and (4) M12 hex nuts (**Item #25**). (**FIG 14**)
11. Loosely install the other end of the support straps to the bull bar using (2) M10 hex head cap screws (**Item #18**), (2) M10 flat washers (**Item #19**), and (2) M10 split lock washers (**Item #20**). (**FIG 14**)
12. Align and adjust the bull bar as necessary, then fully tighten all hardware at this time. Torque all M10 fasteners to 30 ft-lbs and M12 fasteners to 55 ft-lbs.

Bull bar hardware assembly (Non-tow hook model)

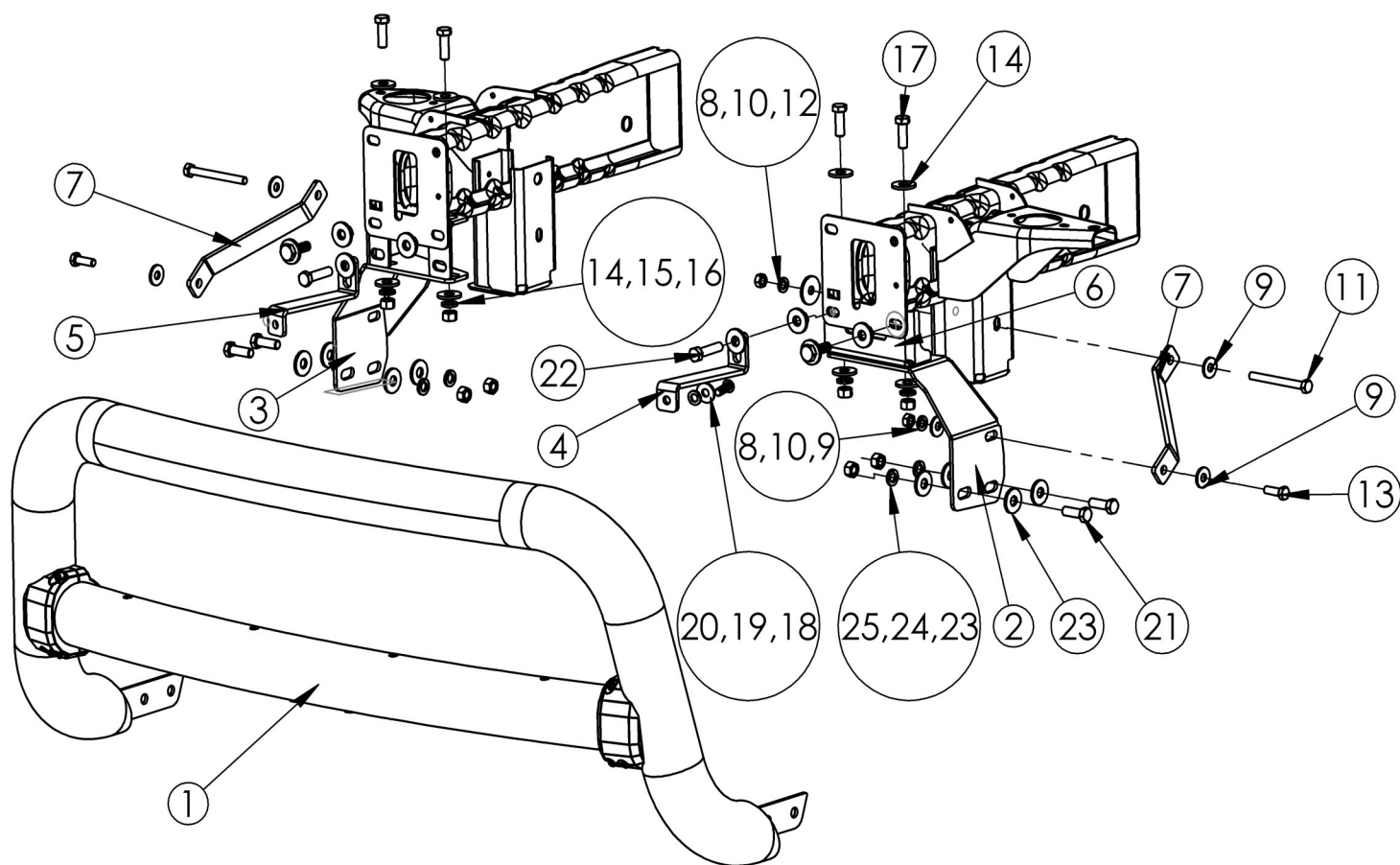

Fig. 14



Westin Automotive Products, Inc.
320 W. Covina Blvd
San Dimas, Ca. 91773

Thank You for choosing Westin products
For Additional installation assistance please call
Customer service (800) 793-7846
www.westinautomotive.com

INSTALLATION COMPLETE



CARE INSTRUCTIONS

- REGULAR WAXING IS RECOMMENDED. DO NOT USE ANY TYPE OF POLISH OR WAX THAT MAY CONTAIN ABRASIVES.
- STAINLESS STEEL PRODUCTS CAN BE CLEANED WITH MILD SOAP AND WATER. STAINLESS STEEL POLISH SHOULD BE USED TO POLISH SMALL SCRATCHES.
- GLOSS BLACK FINISHES SHOULD BE CLEANED WITH MILD SOAP AND WATER.



Westin Automotive Products, Inc.
320 W. Covina Blvd
San Dimas, Ca. 91773

Thank You for choosing Westin products
For Additional installation assistance please call
Customer service (800) 793-7846
www.westinautomotive.com

LIGHT MOUNTING INSTRUCTIONS (lights sold separately)

Light mounted on passenger side shown.

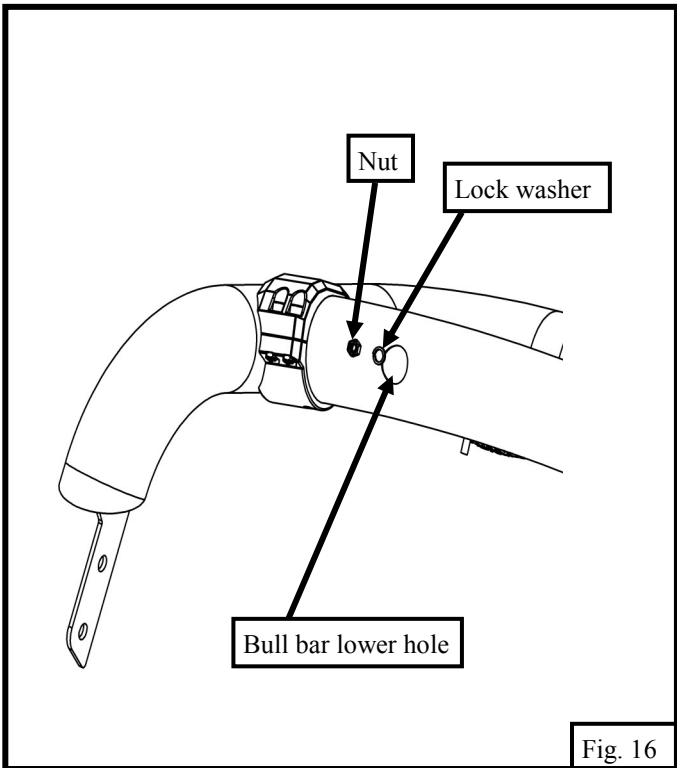
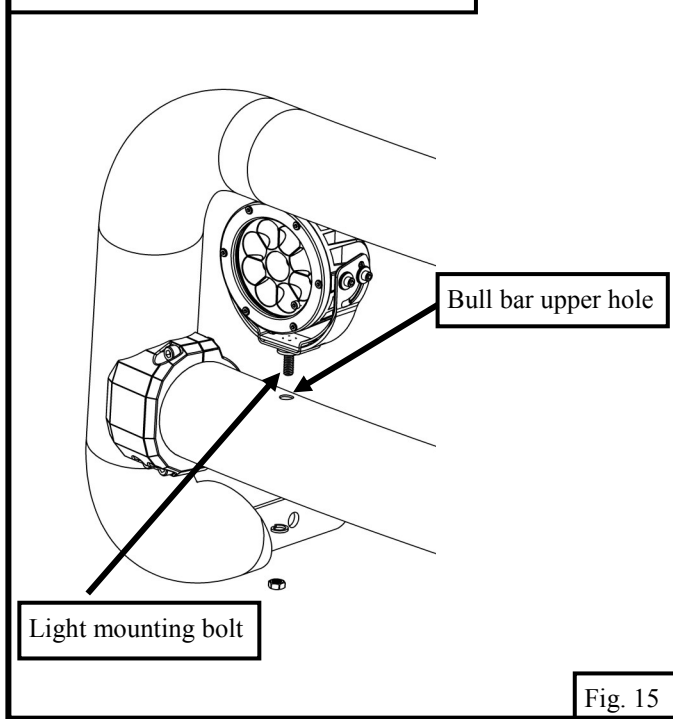

1. In order to mount the post style lights onto the bull bar start by aligning and inserting the mounting bolt of the light onto one of the upper holes in the bull bar. See **Figure 15** for a picture showing this step.
2. From underneath the bull bar, insert the lock washer and nut through the hole as shown in **Figure 16**. **NOTE:** A deep well socket will need to be used in order to fasten the nut to the bolt up through the bull bar. To prevent the washer from falling off while inserting it up through the bolt, use a small piece of tape to tape it to the nut. The tape will shear off once sufficient torque is applied to the nut. Torque the hardware to the specified recommendations.
3. Repeat steps 1 and 2 for the installation of any additional lights.

Westin LED lights mounted on bull bar. (LED lights sold separately).

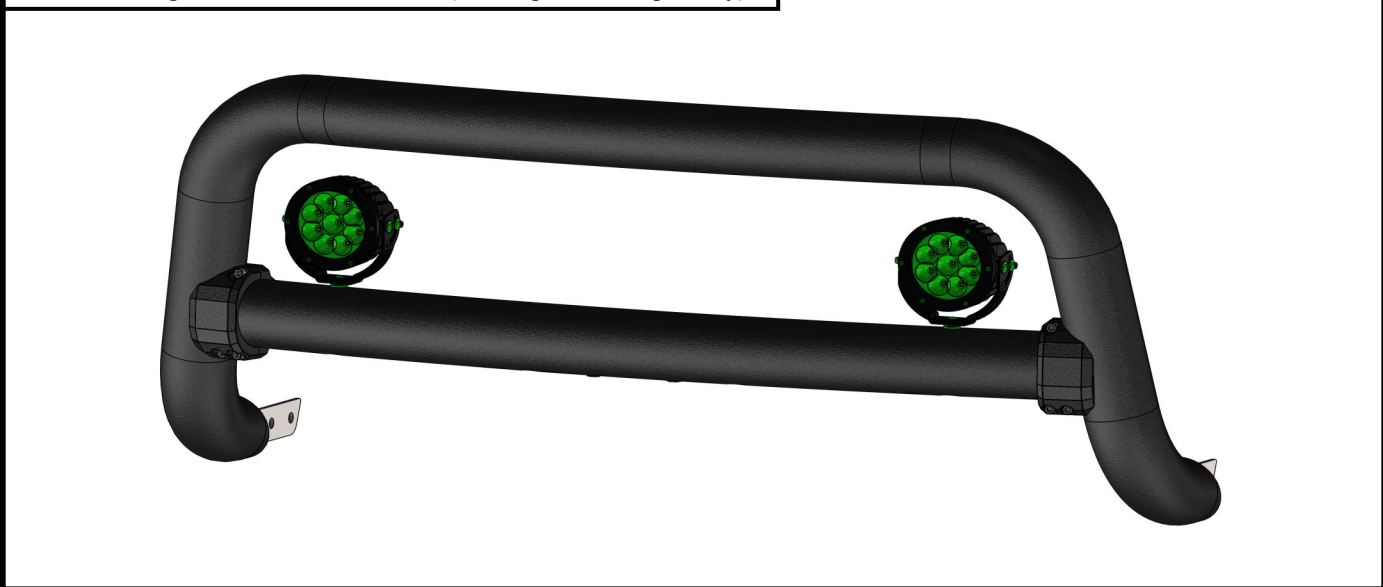

Westin Automotive Products, Inc.
320 W. Covina Blvd
San Dimas, Ca. 91773