



ORACLE LIGHTING

TOYOTA TACOMA TAIL LIGHTS

ORACLE PART #5911-504

INSTALLATION GUIDE

TOOLS NEEDED:
PHILLIPS SCREWDRIVER
10MM SOCKET
SOCKET WRENCH

SCAN QR CODE TO
WATCH INSTALL VIDEO

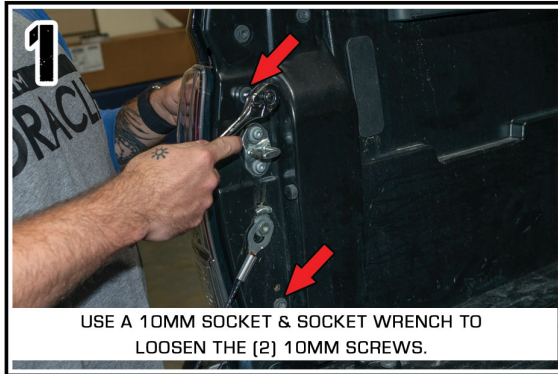

USE A 10MM SOCKET & SOCKET WRENCH TO LOOSEN THE (2) 10MM SCREWS.



WITH THE (2) SCREWS REMOVED, PULL TO DISENGAGE CLIPS THAT ARE ATTACHING THE TAIL LIGHT TO THE TRUCK.

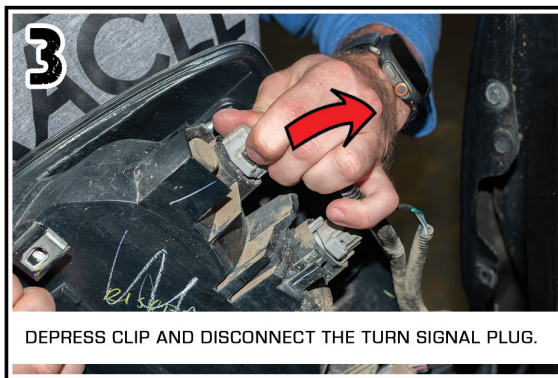

DEPRESS CLIP AND DISCONNECT THE TURN SIGNAL PLUG.

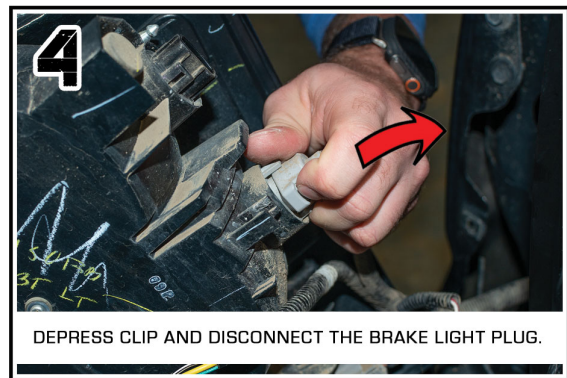

DEPRESS CLIP AND DISCONNECT THE BRAKE LIGHT PLUG.



DEPRESS CLIP AND DISCONNECT THE REVERSE LIGHT PLUG.



PLUG RESISTOR INTO ORACLE TAIL LIGHT HARNESS

USE PROVIDED HARDWARE TO ATTACH THE RESISTOR & METAL BRACKET. INSTALL TO CHASSIS USING CLIPS.



MAKE SURE TAIL LIGHT CLIPS ARE ENGAGED.

PLUG IN NEW TAIL LIGHT HARNESS TO THE FACTORY TRUCK HARNESS. INSTALL ORACLE TAIL LIGHT.

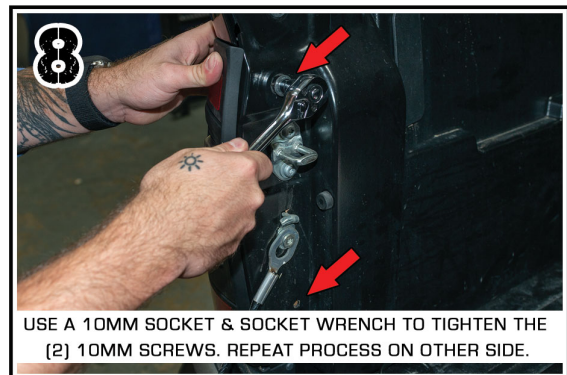

USE A 10MM SOCKET & SOCKET WRENCH TO TIGHTEN THE (2) 10MM SCREWS. REPEAT PROCESS ON OTHER SIDE.