



ORACLE LIGHTING

BRONCO FLUSH TAIL LIGHTS

ORACLE PART #5892-504

INSTALLATION GUIDE

TOOLS NEEDED:
PHILLIPS SCREWDRIVER,
BMM&10MM SOCKET, SOCKET
WRENCH, EXTENSION, SNIPS

STEP: 1

WATCH THE VIDEO
SCAN QR OR VISIT:



WWW.VIMEO.COM/ORACLELIGHTS/BRONCOTAILS



REMOVE THESE 2 SCREW RIVETS ALONG THE TAIL LIGHT, INSIDE THE CARGO SPACE.



THE THIRD SCREW RIVET IS RIGHT BELOW THE SCREW RIVET MARKED "B" FROM THE PREVIOUS STEP.



UNDER THE REAR FENDER, UNLATCH THIS LEVER. PULL FENDER AWAY FROM VEHICLE FOR CLEARANCE.



DETACH THIS LOWER PANEL, BELOW THE OEM TAIL LIGHT.

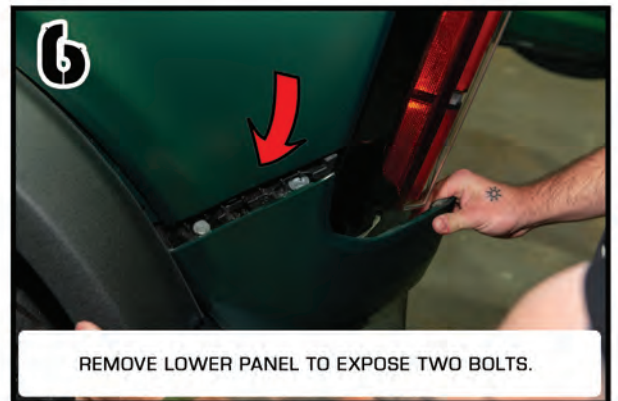

REMOVE LOWER PANEL TO EXPOSE TWO BOLTS.

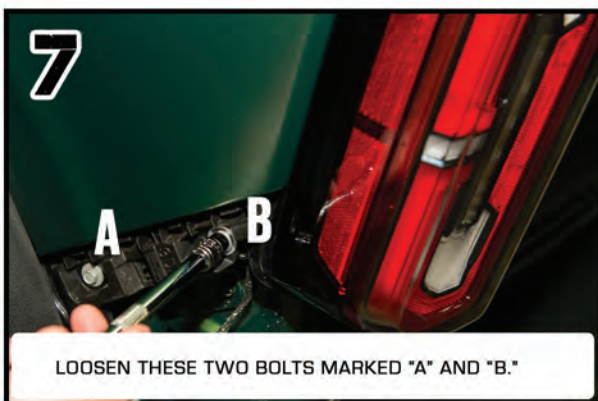

LOOSEN THESE TWO BOLTS MARKED "A" AND "B."



LOOSEN ONE MORE BOLT AT THE LOWER BASE OF THE OEM TAIL LIGHT.



www.oraclelights.com

© 2022 ORACLE LIGHTING

4401 Division St.
Metairie, LA 70002

FOR ADDITIONAL TECHNICAL SUPPORT PLEASE CALL US 1(800)407-5776



ORACLE LIGHTING

BRONCO FLUSH TAIL LIGHTS

ORACLE PART #5892-504

INSTALLATION GUIDE

TOOLS NEEDED:
PHILLIPS SCREWDRIVER,
BMM&10MM SOCKET, SOCKET
WRENCH, EXTENSION, SNIPS



9
REMOVE THIS INNER TRIM PIECE TO EXPOSE TWO BOLTS.

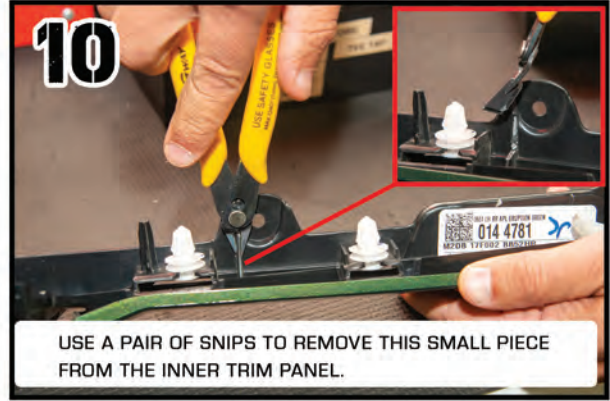

10
USE A PAIR OF SNIPS TO REMOVE THIS SMALL PIECE FROM THE INNER TRIM PANEL.



11
LOOSEN THESE TWO BOLTS. LOCATIONS ARE MARKED "A" AND "B."



12
UNPLUG TAIL LIGHT AND REMOVE FROM VEHICLE.



13
MAKE SURE RESISTOR IS ATTACHED TO THIS METAL BRACKET. CLIP BRACKET TO NEW TAIL LIGHT.



14
CONNECT PLUG FROM NEW FLUSH MOUNT TAIL LIGHT TO FACTORY TAIL LIGHT HARNESS.

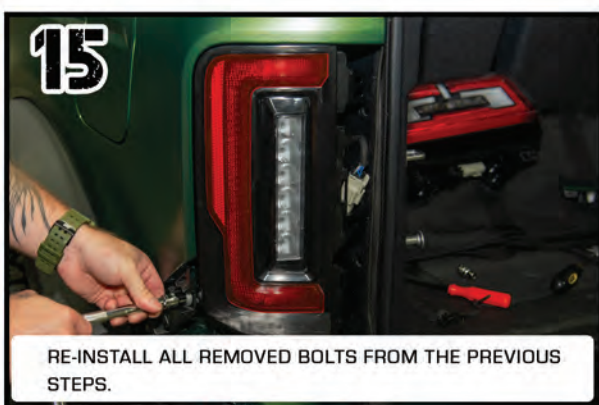

15
RE-INSTALL ALL REMOVED BOLTS FROM THE PREVIOUS STEPS.



16
RE-INSTALL INNER TRIM PIECE, LOWER PANEL FROM STEP 5, SCREWS FROM STEP 1, FENDER LATCH FROM STEP 4.