

# S5332

2001-2004 TOYOTA TACOMA,  
2.4L/2.7L & 3.4L, EXTENDED/CREW CAB,  
CAT BACK, 2.5" SINGLE TURNDOWN

# MBRP®

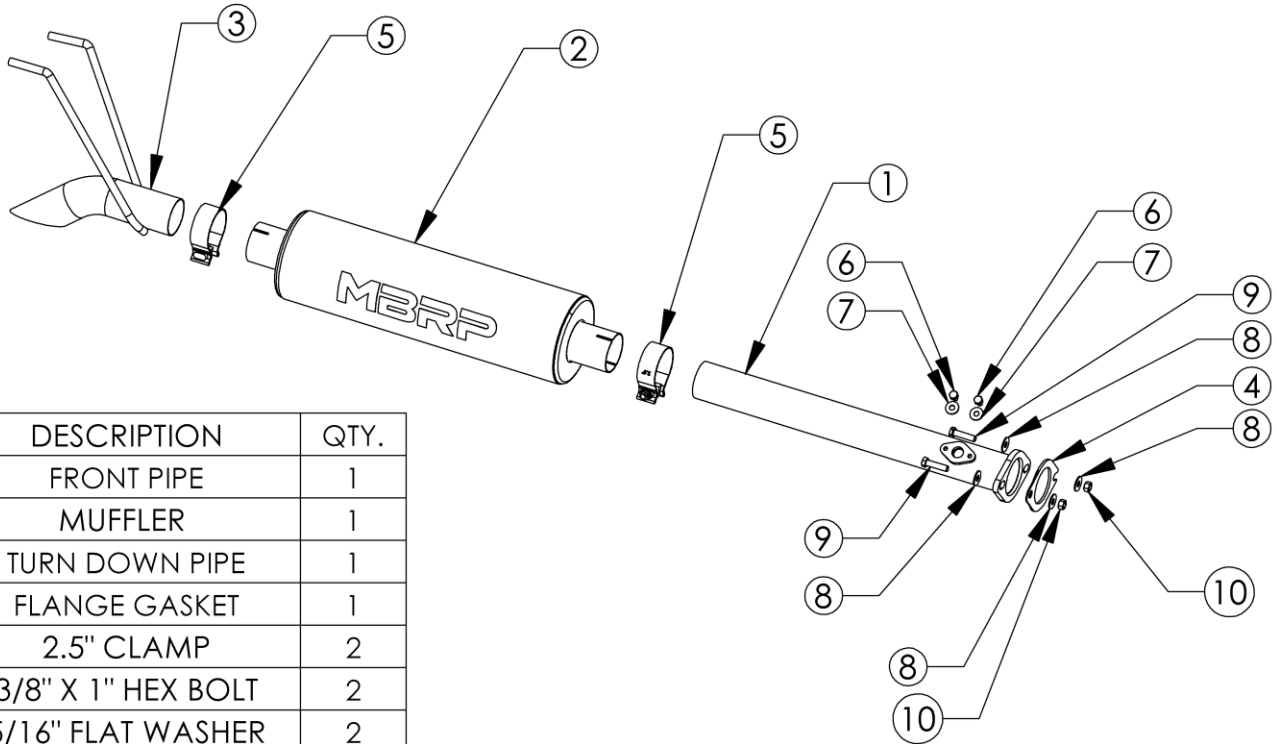

ITEM	DESCRIPTION	QTY.
1	FRONT PIPE	1
2	MUFFLER	1
3	TURNDOWN PIPE	1
4	FLANGE GASKET	1
5	2.5" CLAMP	2
6	3/8" X 1" HEX BOLT	2
7	5/16" FLAT WASHER	2
8	3/8" FLAT WASHER	4
9	3/8" X 1" HEX BOLT	2
10	3/8" HEX NUT	2

## PLEASE READ BEFORE STARTING INSTALLATION

While MBRP has made every effort to ensure that all components of this system are of superior quality and properly packaged, it is the installer's responsibility to ensure the following before removal of the factory exhaust:

- that ALL components shown above are present.
- that ALL mating components fit together.
- that there are no damaged components.
- that the system you have purchased is appropriate for your vehicle year, model and configuration.
- that the system will not interfere with any modifications previously installed or planned.
- that you have read and understand these instructions.

If you have any questions or are uncertain about any aspect of the installation of this system to your vehicle please contact your dealer before commencing installation.

# MBRP®

## Removal of Stock System:



**Figure 1**

1. Apply a penetrating lubricant liberally to all exhaust fasteners, hangers and rubber insulators.



**Figure 2**

2. Loosen the nuts that fasten the rear Oxygen sensor and remove the sensor from the stock exhaust system. Keep the existing gasket for the oxygen sensor as it will be needed for install. **Refer to Figure 1.**

3. Loosen the bolts on the flange in front of the Oxygen sensor. **Refer to Figure 1.**



**Figure 3**

4. Remove the hangers from the rubber insulators and remove the exhaust from the vehicle. If a hoist or hydraulic lift is not being used the tail pipe may need to be cut to clear the rear axle.

## Installation of MBRP Performance Exhaust:



**Figure 4**

1. Install the **Front Pipe** to the existing flange using the fasteners and gasket provided. **Refer to Figure 2.**

2. Install the Oxygen sensor in to the flange on the **Front Pipe** and fasten with the hardware provided. Re-use the existing gasket. Heat resistant silicon may be required depending on condition of existing gasket. **Refer to Figure 3**

3. Place **2.5" Clamp** on to the front of the **Muffler** and install the muffler on to the **Front Pipe**. **Refer to Figure 4.**



**Figure 5**

# MBRP<sup>®</sup>

4. Loosely install a 2.5” **Clamp** on the exit of the muffler and insert the **Turn-Down Tip** into the muffler. Slide both hangers into the stock rubber insulator. **Refer to Figure 5.**

5. Tighten all hardware and clamps, starting at the front and working rearward to secure the system. Check along the full length of the exhaust system to ensure there is adequate clearance for fuel lines, vent lines, brake lines, frame, bodywork, suspension and any wiring, etc. If there is any interference detected, relocate or adjust to provide adequate clearance. Ensure all clamp connections are secure and components are unable to rotate or slide. Band clamps require approximately 45 lb-ft (60 N-m) of torque. Verify clearances, system security and band clamp torque after 30-60 miles (50-100 km) of driving.

**Congratulations!** You are ready to begin enjoying the improved performance and driving experience of your **MBRP** Performance Exhaust system. We hope you enjoy your purchase!