



Installation Instructions

For Part Numbers:

310-313 700-466 Airaid Oiled Media Filter

311-313 701-466 SynthaMax Dry Media Filter - Red

2014-18 JEEP Cherokee

3.2L-V6

NOT LEGAL FOR SALE OR USE ON ANY POLLUTION CONTROLLED MOTOR VEHICLE IN CALIFORNIA OR STATES ADOPTING CALIFORNIA EMISSION PROCEDURES.

See Airaid.com for CARB status on each part for a specific vehicle

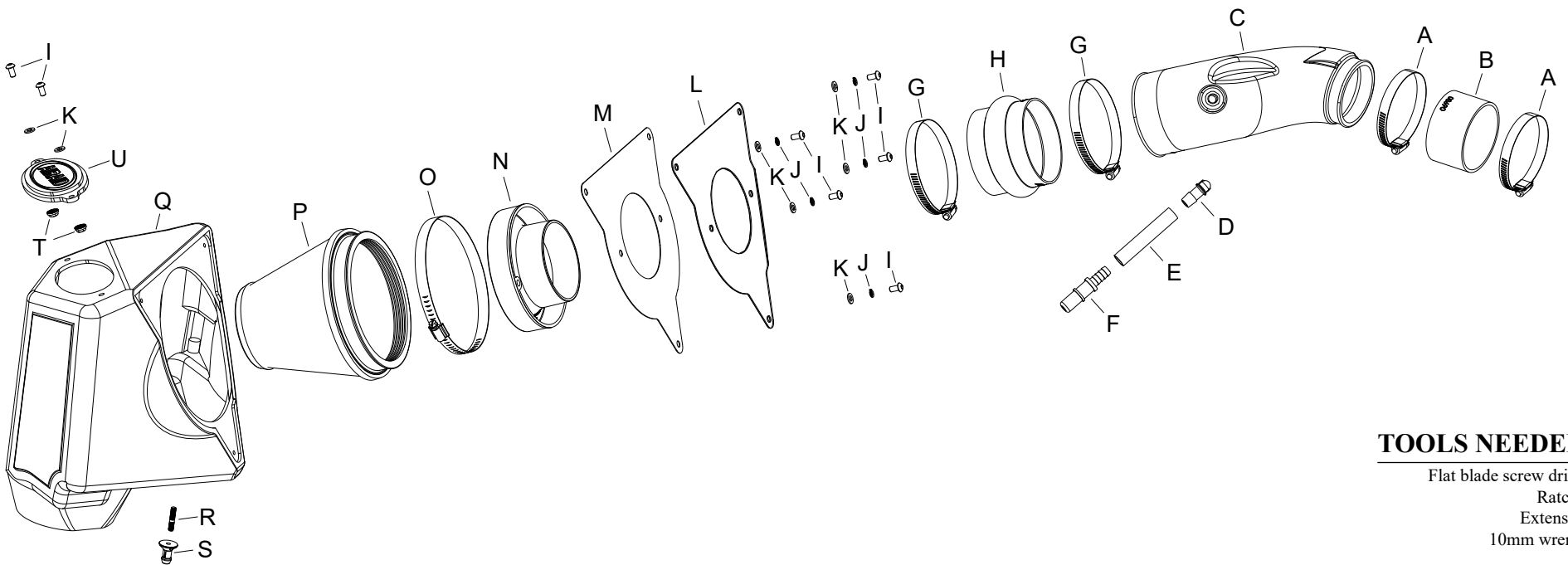

TOOLS NEEDED:

- Flat blade screw driver
- Ratchet
- Extension
- 10mm wrench

Component Identification

Description	Qty.	Part #	Description	Qty.	Part #	Description	Qty.	Part #
A HOSE CLAMP #52	2	08610	H HOSE; HUMP 4"ID X 3"L	1	08418	O CLAMP; #104, 9/16", SS	1	KITHS104
B HOSE; 3.25"ID X 2"L REIN	1	08690	I BOLT; M6 X 1.00 X 16MM, SS	7	07730	P CONE; 6" FLG, 7-1/2"B, 3-7/8"T	1	700/701-466
C TUBE; INTAKE, 31%-313	1	KIT313A	J WASHER, M6 SPLIT LOCK ZINC	5	1-3025	Q AIR BOX; COLD 31%-313	1	KIT313CABA
D VENT; 90 DEG, 1/2"HOSE, 1/4"	1	08110FK	K WASHER; 6MM FLAT, SS	7	08269	R STUD; M6-1 X 30 DBL ENDED	1	1-107
E HOSE; 1/2" ID X 3-1/2" L	1	087028	L LID; AIR BOX, 31%-313	1	KIT313LID	S MOUNT, PLASTIC AIRBOX	1	8-186-1
F FITTING; VENT 1/2" BARB	1	82629	M GASKET; LID 31%-313	1	KIT313G	T NUT; M6, HEX, SERRATED	2	444.460.04
G HOSE CLAMP #64 STAINLESS	2	08645	N ADAPTOR; 57-3058 #454	1	27300	U PLATE; AIRAID LOGO - CLEAR	1	KITLOGOP

Full color instructions can be viewed on our web site at Airaid.com. If you need any assistance please call 1-800-498-6951 to speak with a representative in our Customer Service Center before returning the product.

TO START:

1. Turn off the ignition and disconnect the negative battery cable.

NOTE: Disconnecting the negative battery cable erases pre-programmed electronic memories. Write down all memory settings before disconnecting the negative battery cable. Some radios will require an anti-theft code to be entered after the battery is reconnected. The anti-theft code is typically supplied with your owner's manual. In the event your vehicles anti-theft code cannot be recovered, contact an authorized dealership to obtain your vehicles anti-theft code.



2. Lift up and remove the decorative engine cover to remove it from the engine.



3. Loosen the hose clamps that secure the factory intake tube and then remove the intake tube from the engine.



4. Disconnect the crank case quick connect fitting from the factory air filter housing. Pull up firmly on the air filter housing and remove it from the vehicle.
NOTE: AIRAID recommends that customers do not discard factory air intake.



5. Install the AIRAID window into the AIRAID air filter housing using the provided hardware.



6. Install the stud provided into the air filter housing mount as shown.



7. Install the air filter mount into the air filter housing as shown.

Continued...



8. Install the radius adapter into the air filter as shown and secure with the provided hose clamp.



9. Install the air filter housing gasket and lid onto the radius adapter and secure with the provided hardware.



10. Install the air filter assembly into the air filter housing and secure with the provided hardware.



11. Remove the two mounting grommets from the factory air filter housing and install them into the AIRAID air filter housing as shown.



12. Install the AIRAID air filter housing assembly into the vehicle as shown so that it secures onto the factory housing mounting locations.



13. Install the provided coupler hose (08690) onto the intake plenum and secure with the provided hose clamps



14. Install the provided coupler hose (08418) onto the filter adapter and secure with the provided hose clamp.



15. Assemble the provided quick disconnect fitting, crank case hose and 90° npt fitting as shown.



16. Install the assembled crank case hose assembly onto the AIRAID intake tube as shown.
NOTE: Plastic NPT fittings are easy to cross thread. Install the vent fitting "hand" tight, then turn it two complete turns with a wrench.



17. Install the intake tube assembly into the coupling hoses, adjust for best fit and then secure with the provided hose clamps.



18. Connect the factory crank case quick connect fitting to the quick connect fitting installed onto the AIRAID intake tube.



19. Reinstall the decorative engine cover.
NOTE: It may be necessary to adjust the intake tube for clearance with the engine cover.



20. **Double check your work!** Make sure there is no foreign material in the intake path. Make sure all clamps, hoses, bolts, and screws are tight. Double check the hood clearance!
Reconnect the negative battery cable!

Thank you for purchasing the Airaid Intake System. Contact Airaid @ (800) 498-6951 8:00 AM - 5:00 PM MST weekdays for questions regarding fit or instructions that are not clear to you. Your Airaid Intake System was carefully inspected and packaged. Check that no parts are missing, or were damaged during shipping. If any parts are missing, contact Airaid. The air filter element is protected from direct exposure to water and debris; care should be taken not to drive through deep water.

WATER INGESTION IS THE DRIVERS RESPONSIBILITY! The air filter is reusable and should be cleaned periodically.

FILTER IDENTIFICATION

700-466 Airaid Oiled Media

701-466 Airaid SynthaMax Dry Media - Red

For your Oiled media filter we offer the Airaid Tune Up Kit!



P/N 790-551 Aerosol Spray
P/N 790-550 Squeeze Spray



NOT LEGAL FOR SALE OR USE ON ANY POLLUTION CONTROLLED MOTOR VEHICLE IN CALIFORNIA OR STATES ADOPTING CALIFORNIA EMISSION PROCEDURES.

See Airaid.com for CARB status on each part for a specific vehicle

SynthaMax

Synthamax Air Filters **do not** require oil. Service air filter as needed by cleaning with common non-petroleum all-purpose household cleaner and water. Simple Green®, Formula 409® or equivalent works great. Apply cleaner to outside of air filter and allow to soak. Then flush filter clean from the inside out with a garden hose and repeat steps if necessary. Do not apply high pressure water or air to clean filter. Allow filter to air dry and reinstall.