



Assembly, Installation, Operation and Maintenance Instructions Base Rail Bracket Kit Nissan Titan

P/N: 31395

Dealer / Installer:	Provide a copy of these Instructions to the end user of this product. These Instructions provide important operating and safety information for proper usage of this product. Demonstrate the proper use of the product with the end user. Have the end user demonstrate that they understand the proper use of the product.
End User:	Read and follow all instructions included in this manual. Ask your Dealer / Installer for assistance if you do not understand the proper use of the product. Never remove any decals from the product.

*APPLICATION: 2004 – 2015 Nissan Titan King Cab Pick-Ups (w/ 6-1/2' & 8' Bed)
2008 – 2015 Nissan Titan Crew Cab Pick-Ups (w/ 5-1/2' & 7' Bed)*

WARNING! Never exceed the towing capacity of the tow vehicle.

Center Bolt Kit 32059 (sold separately) must be used when towing with a 26K hitch, Goose Neck, or Maneuvering System.

CAUTION: Do not install base rails over plastic bed liners. Plastic bed liners must be cut out of the way. Rails may be installed on spray in liners. Consult spray liner installer for recommended curing time.

Base Rails Not Included

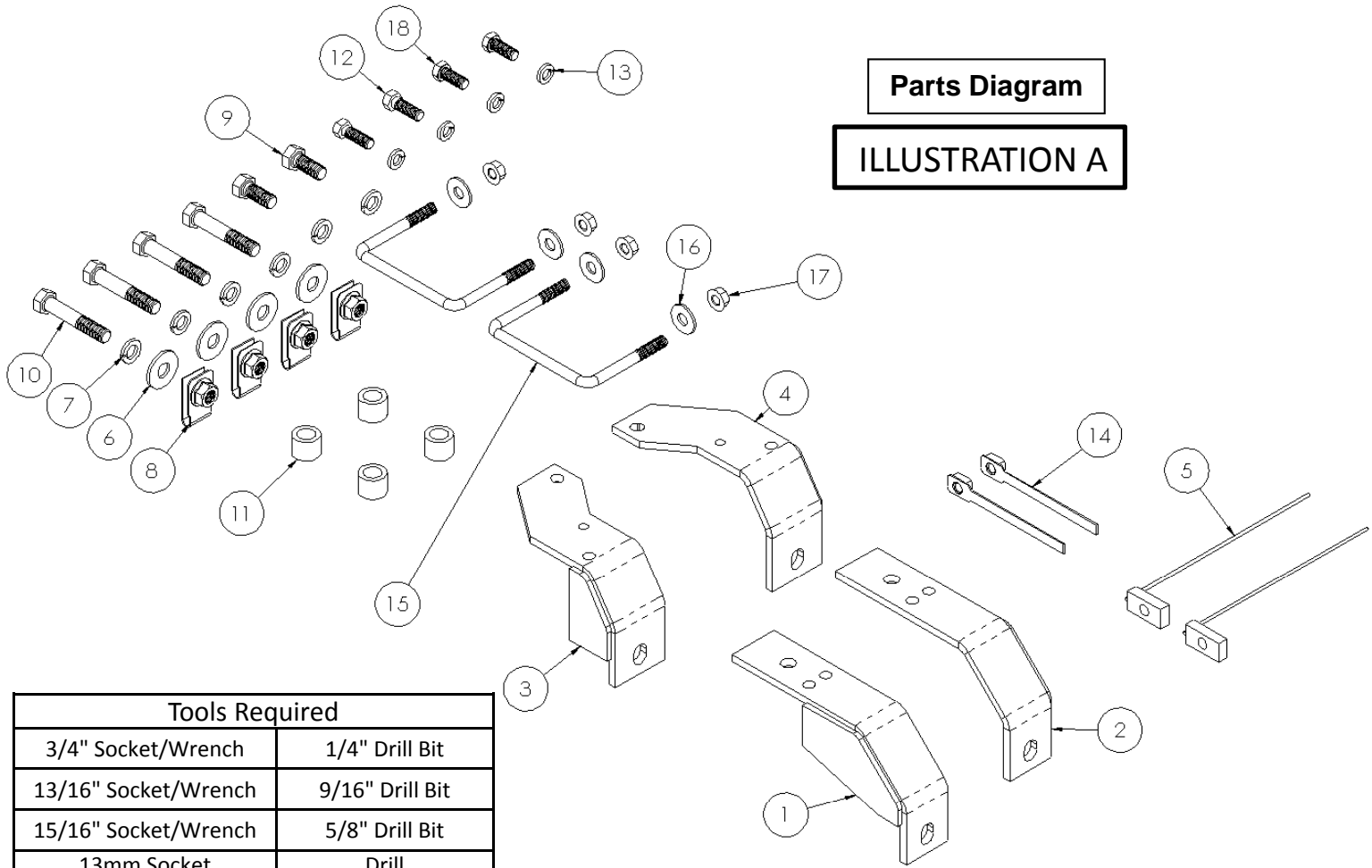

Parts Diagram

ILLUSTRATION A

Tools Required	
3/4" Socket/Wrench	1/4" Drill Bit
13/16" Socket/Wrench	9/16" Drill Bit
15/16" Socket/Wrench	5/8" Drill Bit
13mm Socket	Drill
150 lb. ft Torque Wrench	

Complete Parts List		
Item No.	Description	Qty.
1	Front Passenger side Bracket	1
2	Front Driver side Bracket	1
3	Rear Passenger side Bracket	1
4	Rear Driver side Bracket	1
5	5/8 -11 Tapped Plate	2
6	5/8 " Flat Washer	4
7	5/8" Lock Washer	6
8	5/8 "-11 Clip Nut	4
9	5/8" -11 X 1-1/2" Hex Bolt	2
10	5/8" -11 X 3-1/2" Hex Bolt	4
11	1" Spacer Tube	4
12	1/2" -13 X 1-1/2" Hex Bolt	2
13	1/2" Lock Washer	4
14	Tab Nut Handle	2
15	1/2 "-13 U-Bolt	2
16	1/2" Flat Washer (HD)	4
17	1/2" -13 Locknut Flange Serrated	4
18	1/2" -13 X 1-1/4" Bolt	2

CAUTION:

Do NOT install mounting rails over plastic bed liners. Plastic bed liners must be cut out of the way. Base rails may be installed on dry/cured spray in liner. **Note: Consult installer for recommended curing time.**

Use only the supplied bolts, nuts, and washers to install this kit. All nuts and bolts are Grade 5 unless specified otherwise.

These instructions are guidelines only. Actual installation is the responsibility of the installer and the owner. Always measure truck and trailer before installing hitch to be sure that there is clearance at the cab and at the bumper to allow for turns.

The following instructions should be used to mount the fifth wheel. Care and attention to detail will ensure a quick quality installation. Check parts against parts list to become familiar with parts in kit.

1. The wheel well liners will need to be removed to access the frame for bracket installation.
2. Measurements are given from rear edge of truck bed to rear edge of the base rail closest to the rear edge of truck for most vehicle applications.
3. Place the two bed rails across the truck bed between the wheel wells. Securely attach the 5th wheel cross member to uprights. Position the 5th wheel uprights between the bed rails so that the tabs in the base of each upright will fit into the slots in the bed rails. Secure the uprights in place with the rail hitch pins and hair pins supplied with the 5th wheel installation kit.
4. On most applications, the 5th wheel assembly should be positioned so that it is approximately centered over the truck axle (in this case 2" ahead of axle) and between the wheel wells on the bed floor.

CAUTION:

Check for obstructions before drilling. Failure to do so could result in damaged fuel or brake lines , structural members, etc. HUSKY TOWING PRODUCTS does its best to communicate tow vehicle manufacturer changes; however, it is ultimately the responsibility of the installer to prevent damage due to installation.

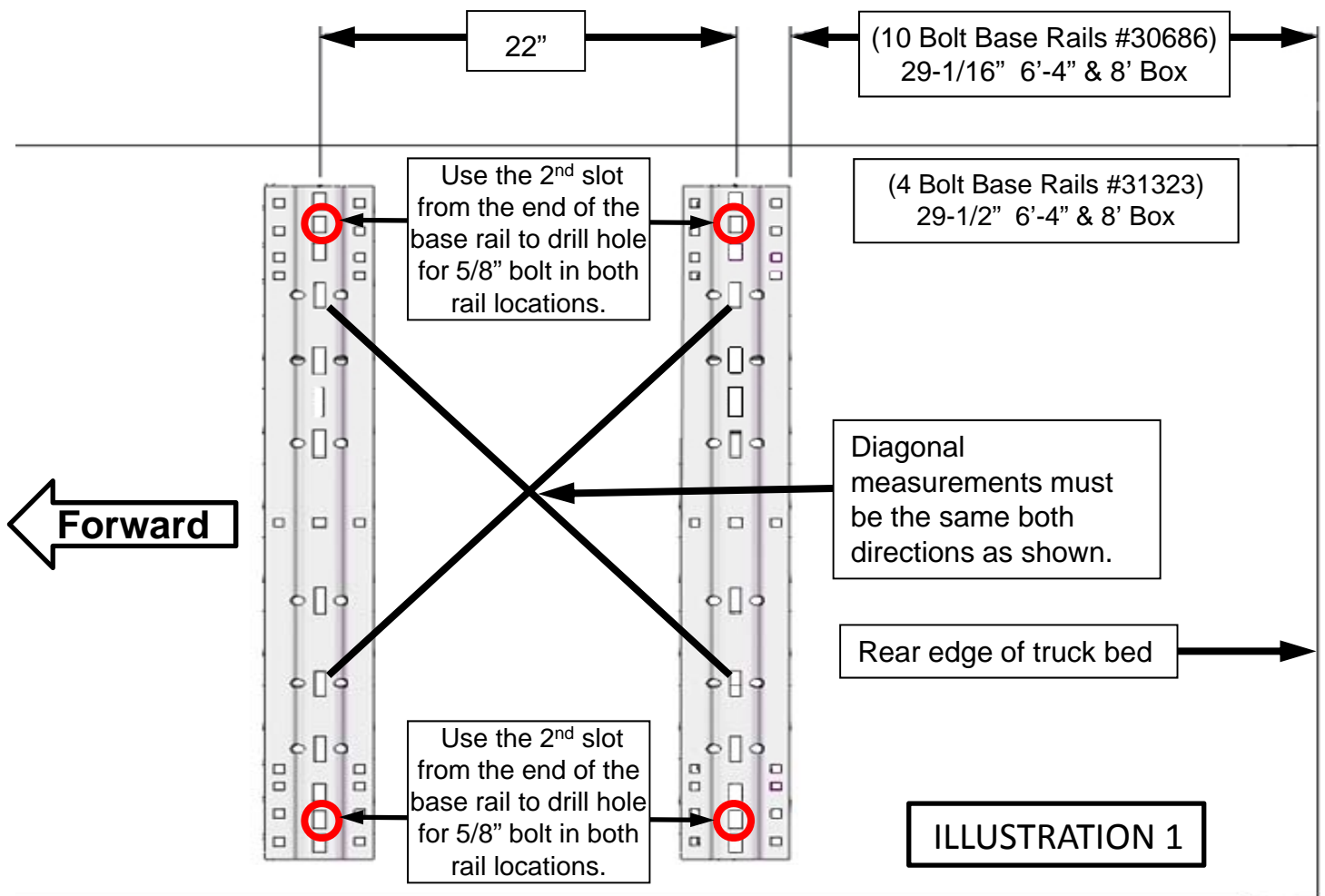

5. Position the bed rail assembly in truck bed as shown on the Illustration 1 on sheet 3 of this instruction sheet. When hitch is correctly positioned in the bed and the bed rails are parallel, mark four attachment points on the truck bed using the 5/8" square holes indicated on the layout Illustration as guides. Check below the bed before drilling holes to see that all wiring, brake lines, or other obstructions are moved out of the way and will not be contacted by the drill. Move the hitch assembly out of the way and drill four 5/8" diameter holes down through the bed at the previously marked points.
6. Before you can install the right rear bracket onto the frame, a hole must be drilled in the side of the frame. See Illustration2 for location of hole to be drilled. This hole will be used to locate the bracket on the frame.
7. Position the right rear bracket #3 against the outer surface of the right side truck frame with the upper formed leg positioned over the top of the frame. Align threaded hole in bracket #3 with drilled hole in truck frame and carefully thread bolt #18 into the tapped hole in bracket and out into hole in side of truck frame. See Illustration 3. Attach bracket to frame with 1/2" U-Bolt #15 as shown on Illustration 3. Leave U-Bolts loose.
- 7a. Repeat installation procedure with left rear bracket #4 on left side frame. Threaded hole in bracket #4 will be positioned over the existing hole in frame. Align threaded hole in bracket #4 with the existing hole in truck frame and carefully thread bolt #18 into the tapped hole in bracket #4 and out into hole in side of truck frame. The upper hole in each bracket must be aligned with previously drilled 5/8" hole in truck bed.

ILLUSTRATION 2

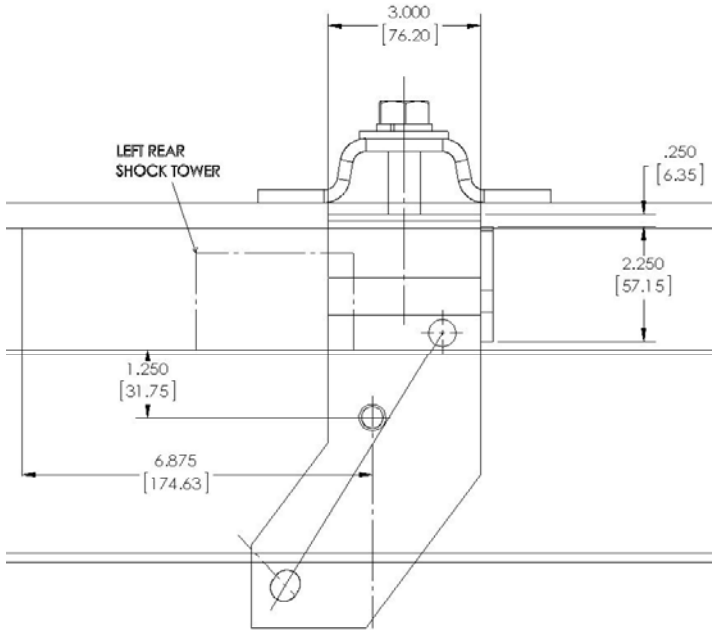

FRONT OF TRUCK →

ILLUSTRATION 3

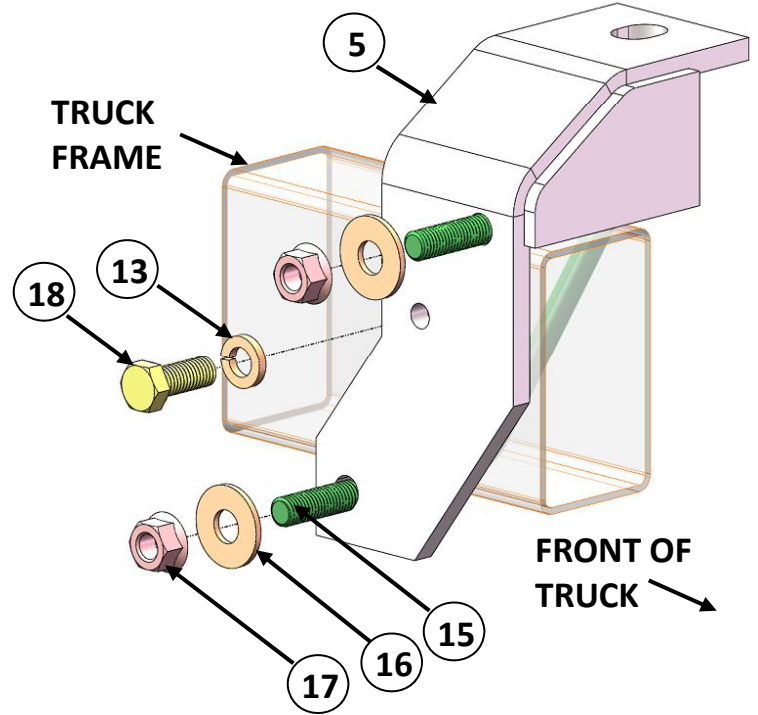

NOTE: After the U-Bolts are installed and torque to specification, the lower leg of the U-bolts may need to be trimmed off to clear leaf springs or suspension parts.

8. Form the wire handle on the tapped plate assembly #5 as shown on Illustration 4. This form will allow the tapped plate to be positioned inside frame over attachment hole.
9. Position the left and right front brackets #1 and #2 against the sides of the left and right truck frame and align with the large hole in frame. This hole will be just above an access slot in frame.

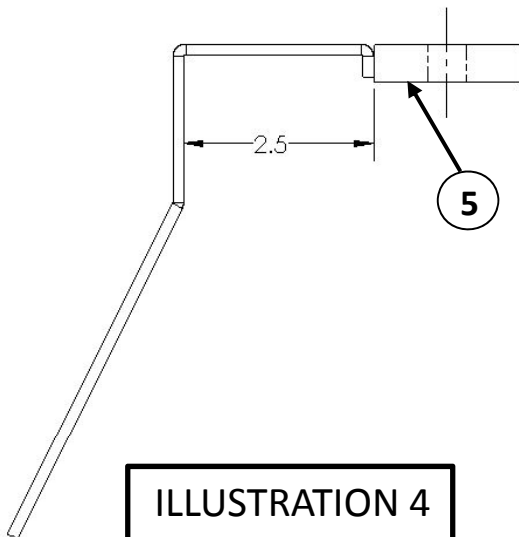

ILLUSTRATION 4

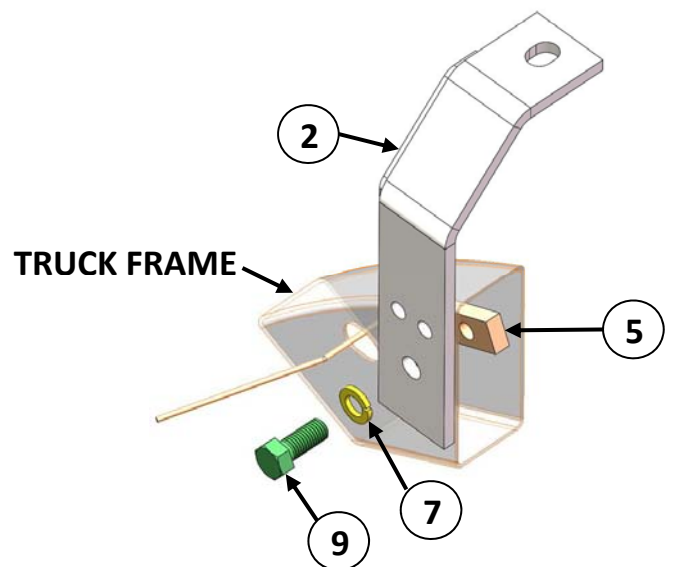
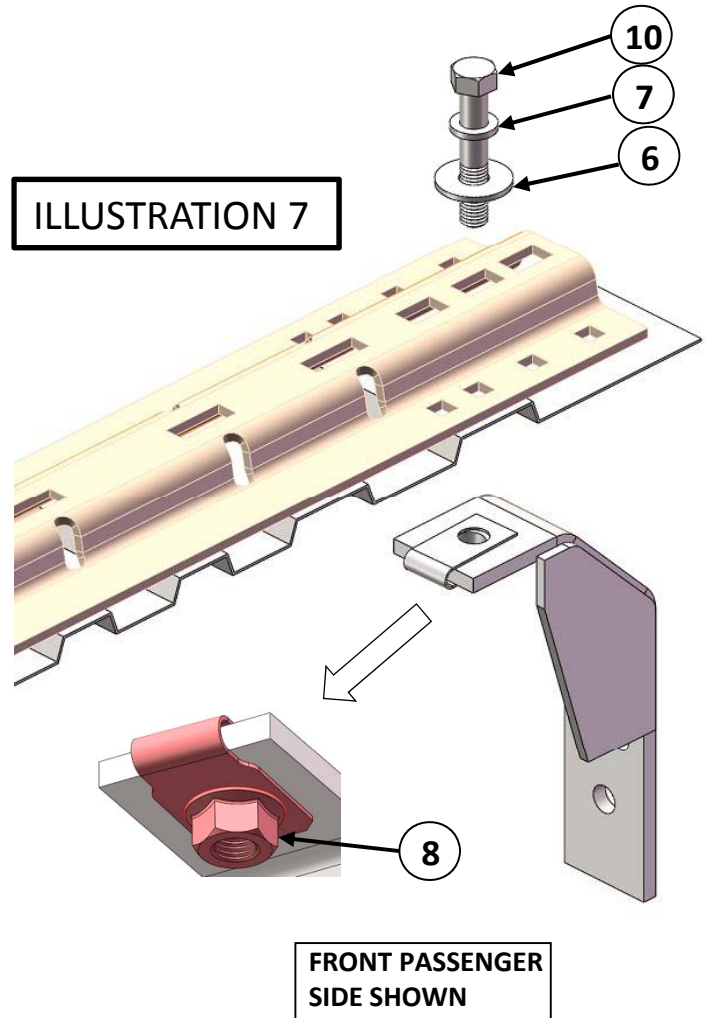
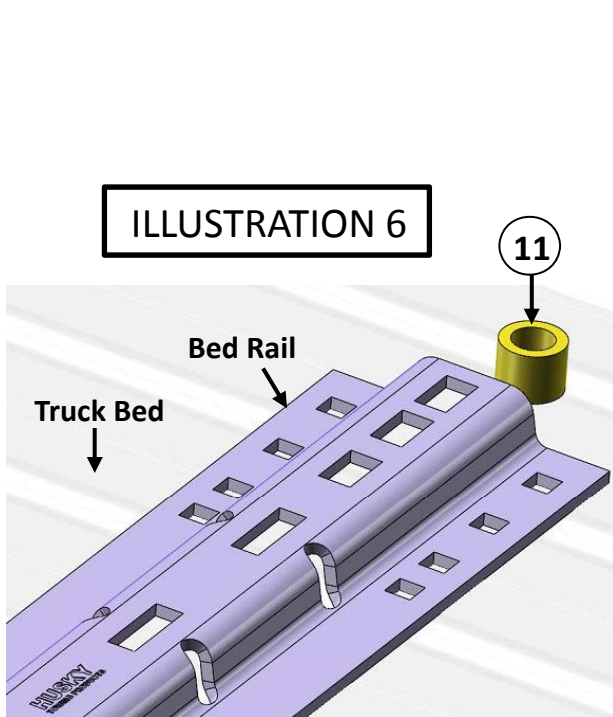

ILLUSTRATION 5

10. Position the tapped plate #5 into left truck frame through the access hole and align over the existing hole in frame. Bolt left bracket #2 to frame with 5/8" fasteners, as shown on Illustration 5. Do not tighten bolt at this time. Repeat procedure on right side frame using right bracket #1.
11. Reposition the bed rails in the bed so that the 2nd square hole in the end of each rail is lined up over the drilled holes. Place a 1" spacer tube #11 under ends of each bed rail. In line with the drilled holes as shown on Illustration 6.
12. Bolt bed rails to truck bed and under bed frame brackets with 5/8" fasteners shown on Illustration 7. Tighten each 5/8" bolt to 150 ft-lbs. torque. Failure to tighten bolts as described may result in fastener loss or failure. **DO NOT** apply torque to the nut portion of the clip nuts (#8). You will **DAMAGE** it.



13. Go back to the front left and right brackets, partially mounted to the truck frame. Near the center of each bracket there are two holes. There should be a hole in the truck frame that will be lined up with the rear hole on each bracket. Enlarge this hole in the frame to accept a 1/2" bolt.

14. Insert a ½" tab nut #14 into frame through the access slot in frame and align with the previously drilled hole. Bolt bracket to frame with ½" bolt #12 and lock washer #13 as shown on Illustration 8.

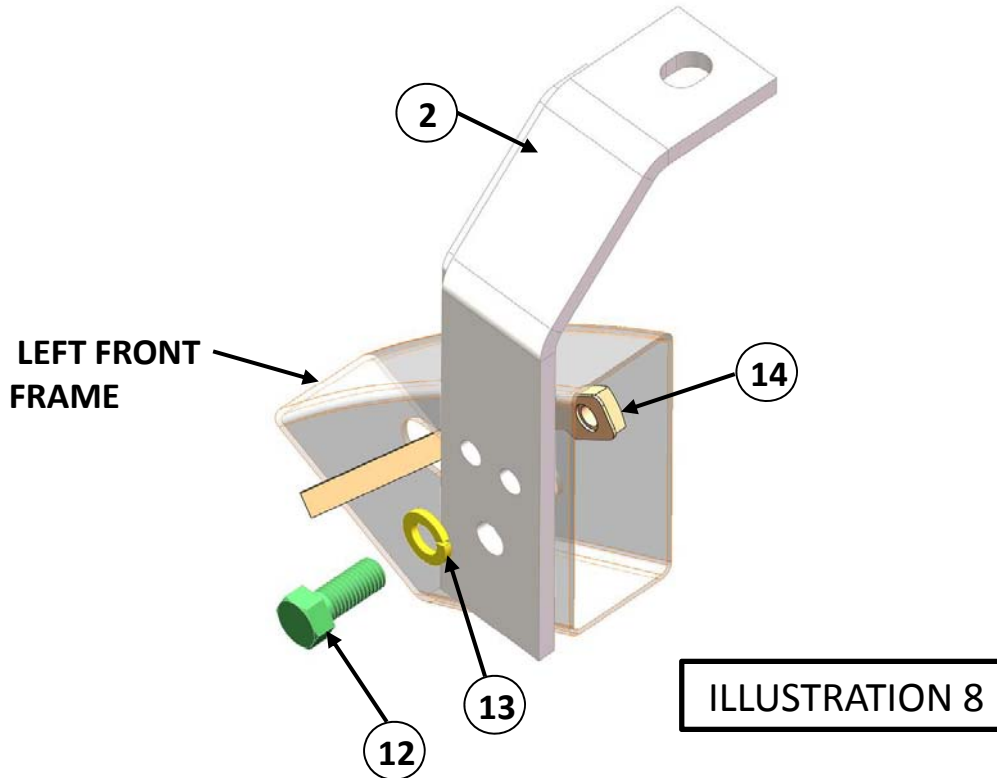

15. Tighten all ½" bolts to 75 ft. – lbs. torque. Failure to tighten bolts as described may result in fastener loss or failure.
16. Re-install the plastic wheel well filler panels removed in step 1 using the original fasteners
17. Check each rail hitch pin for freedom of movement in the bed rail connection. Adjust uprights, if necessary, by placing shim 31582 or 30243 between the upright and the cross member to obtain free pin movement. See Illus.9. Shims 31582 & 30243 sold separately.

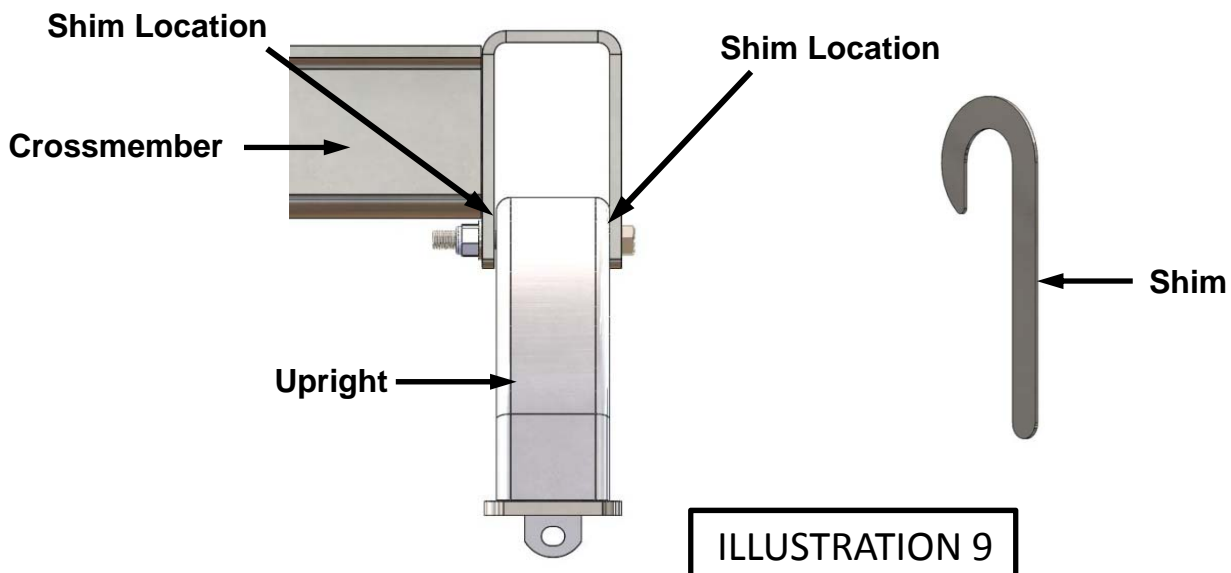

#31395 CUSTOM BRACKET KIT, NISSAN TITAN



HUSKY
TOWING PRODUCTS

WWW.HUSKYTOW.COM

Designed & tested in the USA & Made in China for /
Conçu et testé aux É.-U. et fabriqué en Chine pour
DTS Manufacturing, Wilsonville, OR 97070

P.O. #:

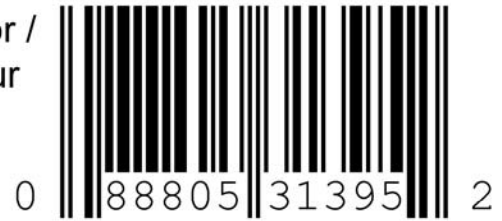

The date code for this product is located on the UPC label

Please retain this info for your records.

Warranty Terms:

5 Year Limited Warranty:

This warranty applies solely to Husky 5th Wheel Installation Kit manufactured by DTS Mfg. for Husky Towing Products.

Husky Towing Products and DTS Mfg. make no guarantees or warranties for products not manufactured by DTS Mfg. Such products are covered solely under any applicable warranty of the manufacturer. It is always recommended that the operating instructions and guarantee instructions provided by the manufacturer are followed.

DTS Mfg. warrants its products to be free from manufacturing and material defects to the original purchaser for the length of warranty stated above from the date of retail purchase. If any products are found to have a manufacturing or material defect, the product will be replaced or repaired at the option of Husky Towing Products and DTS Mfg. with proof of purchase by the original purchaser. The original purchaser shall pay all transportation and shipping costs associated with the return of the defective product and the defective product shall become the property of DTS Mfg.

The Warranty applies to DTS Mfg. products used for individual and recreational purposes. Commercial usage of the DTS Mfg. products limits the warranty to 90-days from date of purchase.

The Warranty applies only to DTS Mfg. products which are found to be defective in manufacturing or material. This warranty does not apply to normal wear and tear of the finished placed on DTS Mfg. products.

Husky Towing Products and DTS Mfg. are not responsible for any labor costs incurred for removal or replacement of the defective product.

Husky Towing Products and DTS Mfg. are not responsible for repair or replacement of any product under the limited warranty where the product was improperly installed, misapplied, altered, abused, neglected, overloaded, misused or damaged as a result of an accident, including any use of the product not in accordance with all product operating and safety instructions.

Without limiting the generality of the foregoing, Husky Towing Products and DTS Mfg. shall under no circumstances be liable for any incidental or consequential loss or damage whatsoever arising out of, or in any way relating to any such breach of warranty or claimed defect in, or non-performance of the products. Some states do not allow the exclusion or limitation of incidental or consequential damages, so the above exclusion or limitation may not apply to you.

This limited warranty gives you specific legal rights, and you may also have other rights that vary from state to state.